

# SLIDING DOOR HARDWARE

## DOOR STOPS

### C-100 IN-TRACK STOP

Compatible tracks: C-300, C-350, C-400, C-411, C-412, C-500, C-538, C-600, C-650, TYPE B & TYPE C Crowderframe Kits

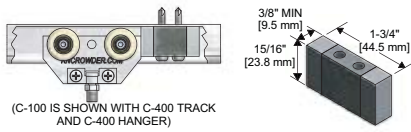

**new**  
& IMPROVED!

### C-100HD IN-TRACK STOP

Compatible tracks: C-104, C-108, C-204, C-975

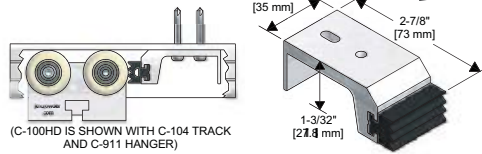

**new**  
& IMPROVED!

### C-101HD IN-TRACK STOP

Compatible tracks: C-104, C-108, C-975

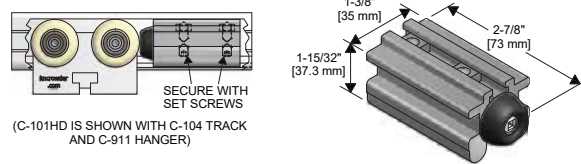
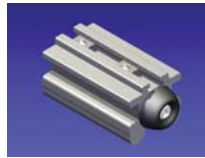

**new**

### C-102HD FLOOR DOOR STOP

Suitable for doors up to 1-3/4" [44.5mm] thick only. Supplied with 4 #10 flathead wood screws & 4 #10 flathead Tapcon screws

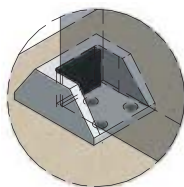
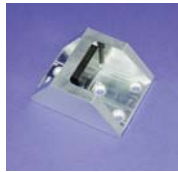

**new**  
& IMPROVED!

### CROWDER DOOR CATCHES

New and creatively designed door catches are made to stop the door and keep it in that position until it is required to be closed or opened.

#### CDC-400

Compatible with: C-400 Track, C-500 Track, C-538 Track and Type B Crowderframe

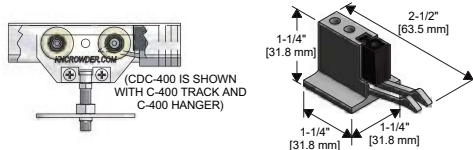

#### CDC-411

Compatible with: C-411 Track, C-412 Track and Type C Crowderframe

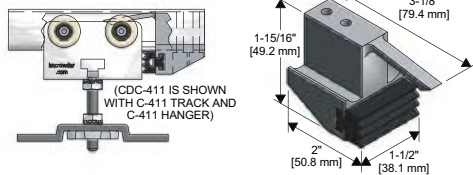

#### CDC-911

Compatible with: C-104 and C-108 Track with C-911 hangers

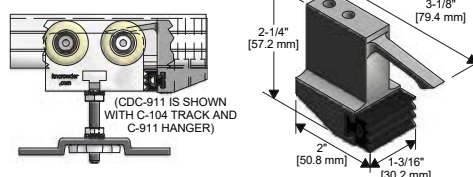

### CAS-1 & CAS-1R END STOPS

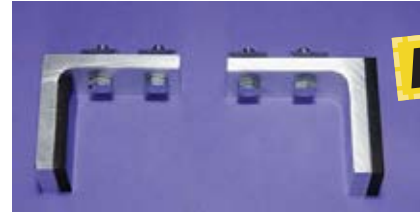

**new**

#### CAS-1

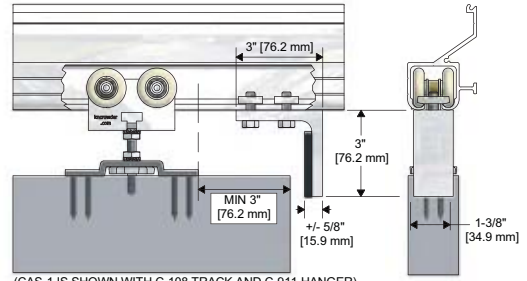

(CAS-1 IS SHOWN WITH C-108 TRACK AND C-911 HANGER)

#### CAS-1R

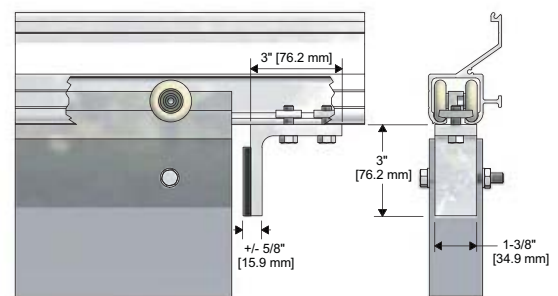

### CAS-2 DOOR STOP (INCLUDES C-100HD STOP)



**new**

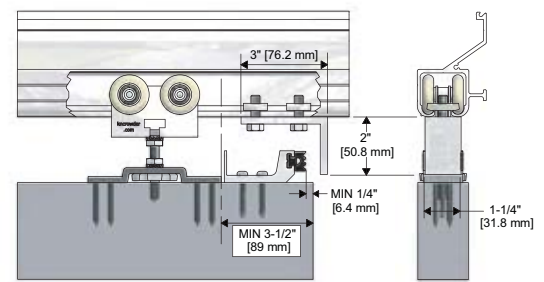

(CAS-2 IS SHOWN WITH C-108 TRACK AND C-911 HANGER)

### C-99 RUBBER DOME BUMPER

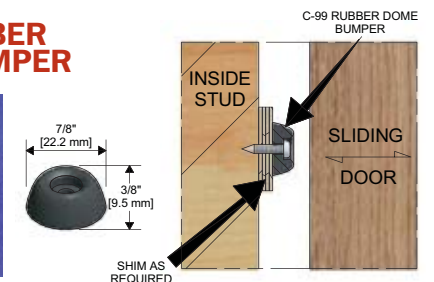

SHIMS REQUIRED