

BI-FOLD & PIVOTING SYSTEMS

MEDIUM TO HEAVY-DUTY

new
& IMPROVED!

C-410 PIVOT KIT C-104 TRACK

This new improved pivot complete with thrust bearings for extra heavy load. The top pivot clamps onto the track and new top plates reduce costs of prepping doors. The **C-994-FP** hanger (supplied) uses the same top plate as pivot end. Hinges by others.

- Use with Extruded Aluminum **C-104 Track**, 6063T5 Alloy
- Load Capacity **150 lbs. per panel/leaf.**

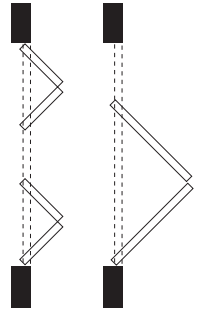

C-410 COMPLETE KIT FOR 2 DOORS BI-FOLDING

BI-FOLDING KITS AVAILABLE FROM 48" [1219MM] TO 144" [3658MM] TRACK WIDTH AND UP TO 4 DOORS.

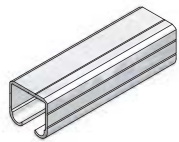

C-104 TRACK X LENGTH (OPENING WIDTH) (1)

KITS COME COMPLETE WITH SCREWS



C-994-FP HANGER (1)



C-410-3 DOOR PLATE (3)

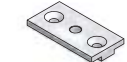

C-410-1 TOP PIVOT PLATE (1)

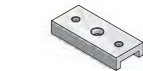

C-410-2 TRACK CLAMP (1)



C-410-4 BOTTOM PIVOT PLATE WITH THRUST BEARING (1)



C-994-FP BOLT (1)



C-410-4 TOP PIVOT STUD (1)



C-410-3 BOTTOM PIVOT STUD (1)

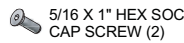

5/16 X 1" HEX SOC CAP SCREW (2)

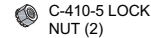

C-410-5 LOCK NUT (2)

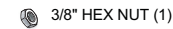

3/8" HEX NUT (1)

OPTIONAL PRODUCTS

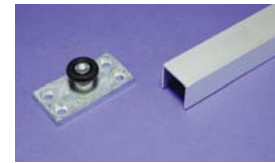

C-913 Guide & C-914 Guide Channel. (See page 70 for more details)

PLAN VIEWS SHOWING CLEARANCE BETWEEN DOORS

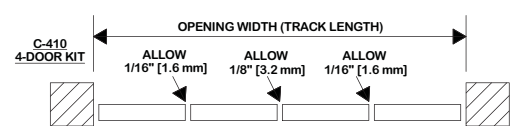
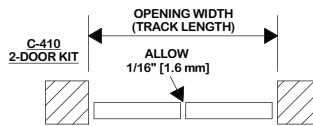

C-410 DETAIL

