

BI-FOLD & PIVOTING SYSTEMS

LIGHT DUTY

CF-100 FOLDING DOOR HARDWARE

Easily mounted hardware features nylon wheel for smooth horizontal action in aluminum track. Spring-loaded pivot and nylon bushings in all moving parts make for silent, easy action. Brackets are adjustable for plumb. Ideal for light or louvre type doors. Maximum door height equals floor to header less 2" [50.8mm]. Minimum door height equals floor to header less 3" [76.2mm]. Hinges by others.

- Use with Extruded Aluminum **CF-100 Track**, 6063T5 Alloy
- Load capacity **20 lbs. per panel/leaf**

Up to 20 lbs. per panel

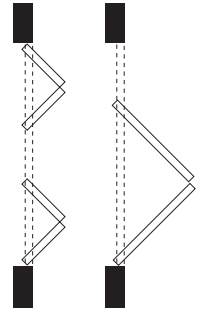

CF-100 COMPLETE KIT FOR 2 DOORS BI-FOLDING

BI-FOLDING KITS AVAILABLE FROM 48" [1219MM] TO 144" [3658MM] TRACK WIDTH AND UP TO 4 DOORS.



CF-100 TRACK X LENGTH (OPENING WIDTH) (1)

KITS COME COMPLETE WITH SCREWS



CF-100-3 TOP SPRING LOADED PIVOT (1)



CF-100-5 ANGLE BRACKET (1)



CF-100-6 NYLON WHEEL GUIDE (1)



CF-100-2 TOP PIVOT PLATE (1)



CF-100-5 BOTTOM PIVOT PLATE (1)



CF-100 NYLON "T" BEARING (2)



CF-100-4 PIVOT STUD (1)



CF-100 NYLON STEP NUT (2)



#10-24 X 1/4" FLANGED HEX HEAD SCREW (2)



5/16" EXTERNAL TOOTH LOCK WASHER (2)



5/16" HEX NUT (2)

OPTIONAL PRODUCTS

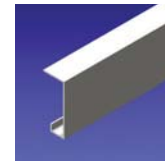

C-118 Fascia. (See Page 67 for more details).

PLAN VIEWS SHOWING CLEARANCE BETWEEN DOORS

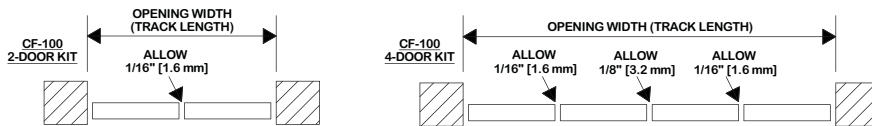

CF-100 DETAIL

