

C-21-BHBH Passage Set

Installation Instructions

KNC
Door Locks & Pulls

Specifications

Door Thickness: 1 3/8 in [34.9 mm] to 2 1/4 in [57.2 mm]

Not to scale

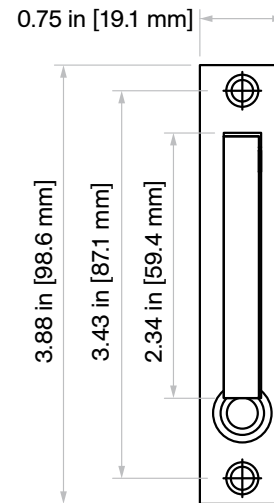
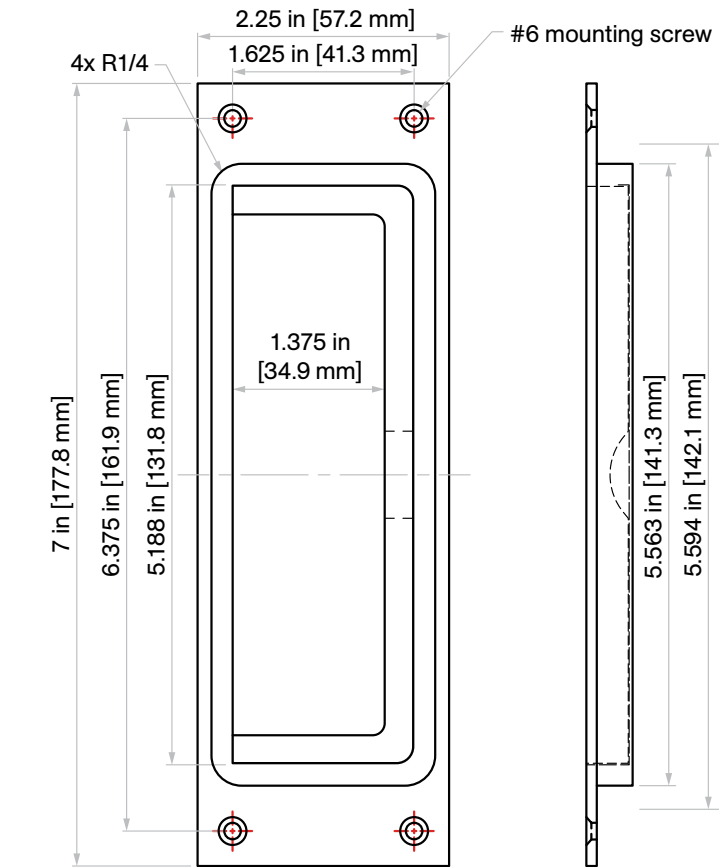

Included Components

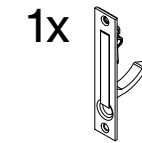

C-21
Edge Pull Body

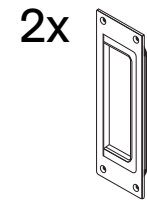

C-90BH
Swing-Out Handle Flush Pull

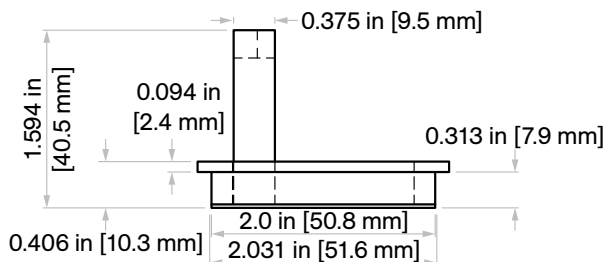
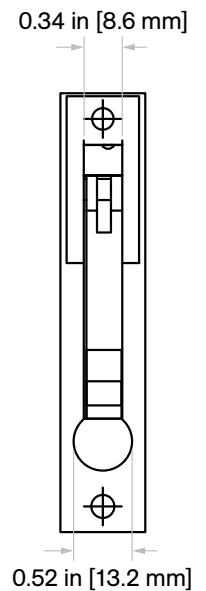
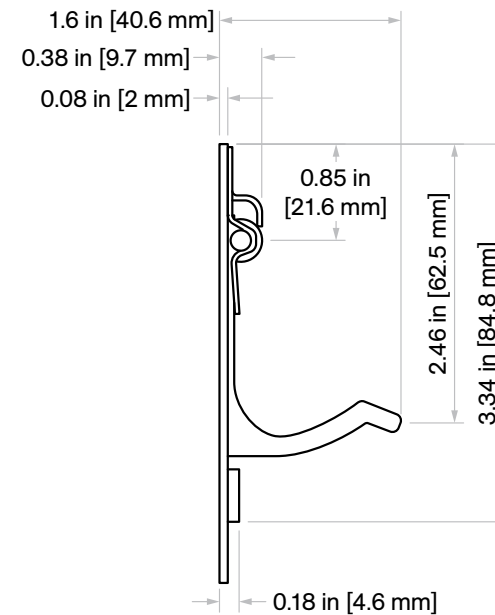

Door Prep Template

Horizontal and vertical spacing of the flush pulls is up to the end user. However, we do suggest to line up the backset with the other locks on your project.

C-90BH

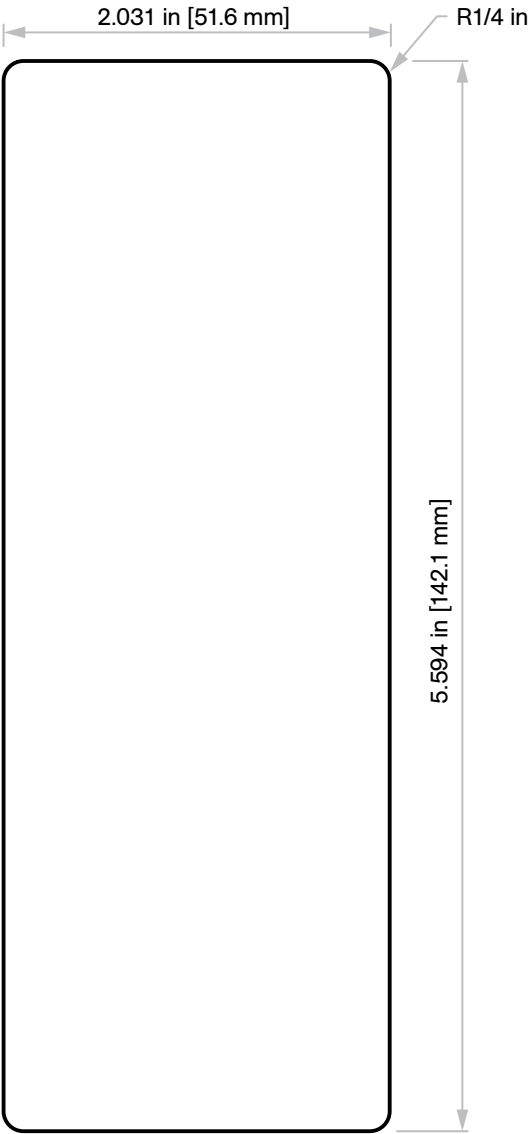

For example: 2 in [50.8 mm], 2.5 in [63.5 mm], 2.75 in [69.8 mm], 5 in [127 mm], and 6 in [152.4 mm]

Responsibility
Door and frame manufacturers are responsible for providing adequate construction or reinforcement for proper installation of hardware shown.

C-21

