

C-61 Edge Pull

Installation Instructions

Spring Loaded Edge Pull

Can be used with a privacy set

Door Thickness: 1 3/8 in [34.9 mm] to 1 3/4 in [44.5 mm]

Not to scale

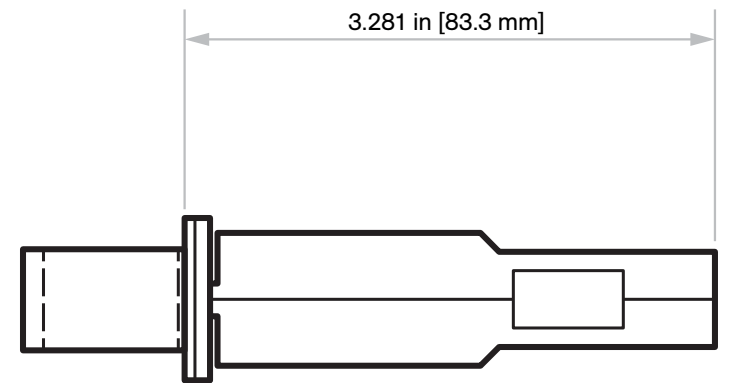
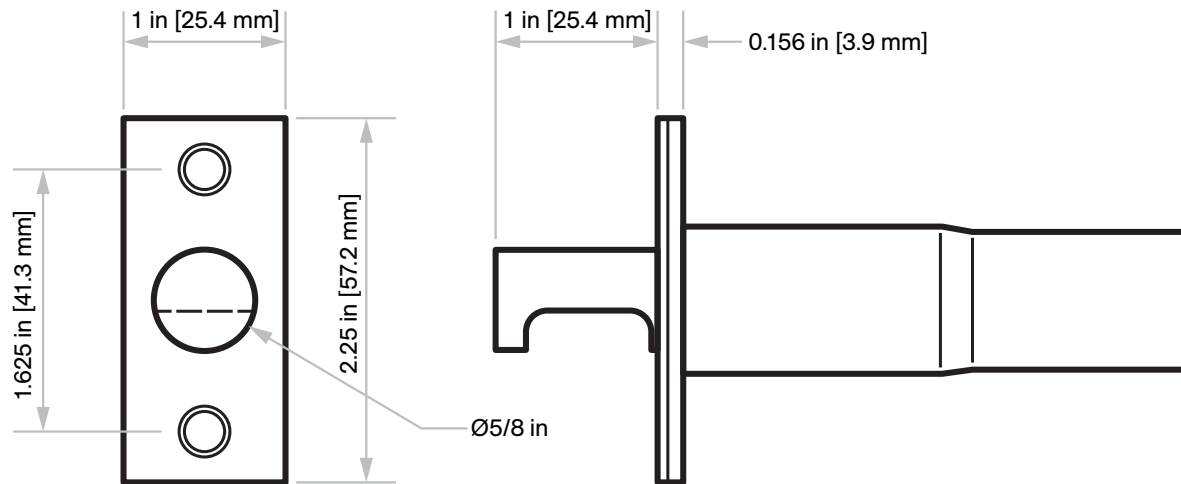
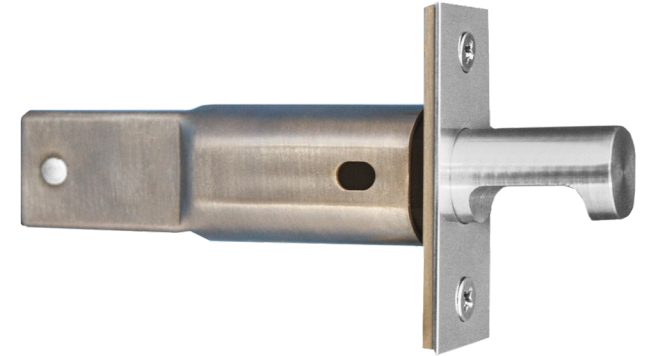

Door Prep Template

Responsibility

Door and frame manufacturers are responsible for providing adequate construction or reinforcement for proper installation of hardware shown.

Not to scale

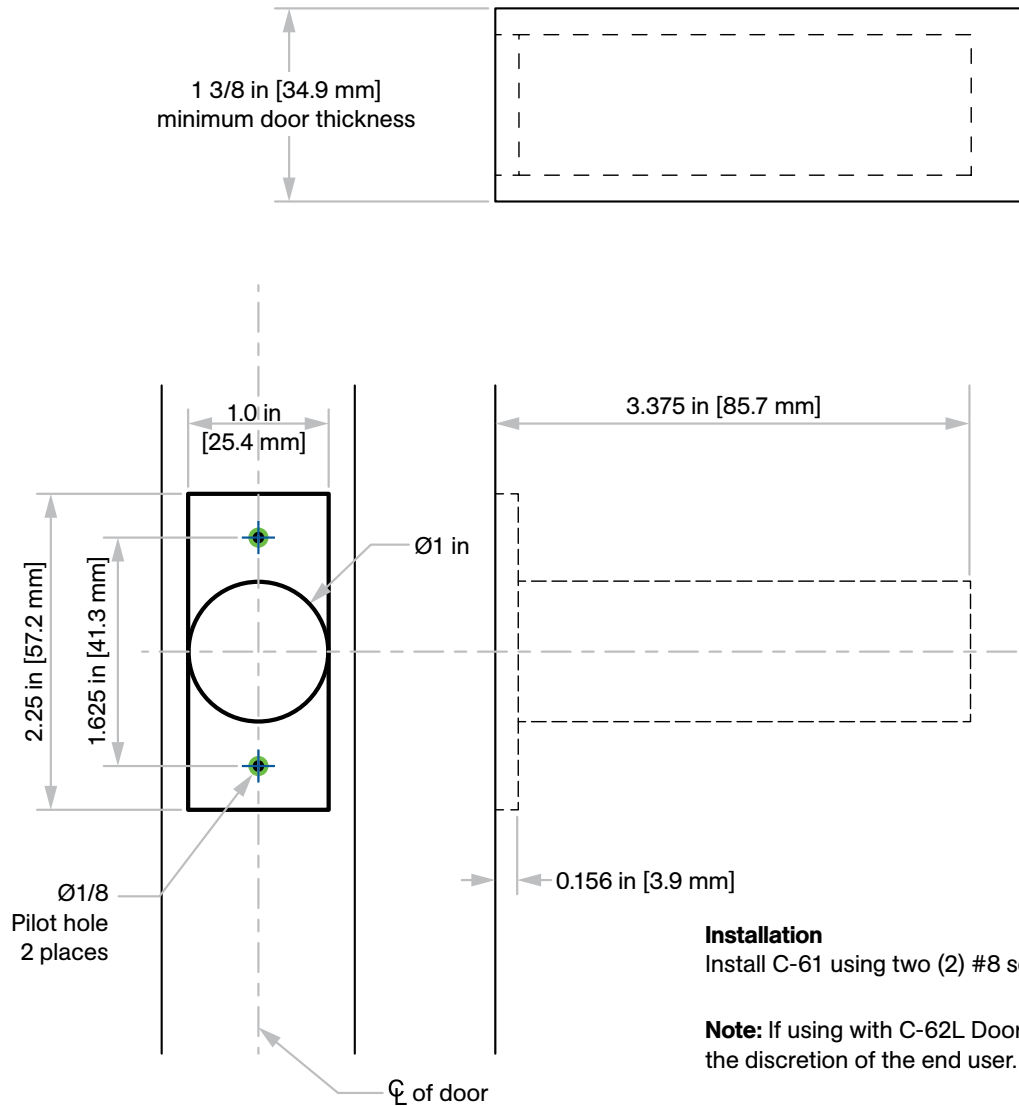

Installation

Install C-61 using two (2) #8 screws provided.

Note: If using with C-62L Door Lock, C-61 is mounted below the C-62L. This location is at the discretion of the end user.

C-62L-RET Privacy Lockset

Installation Instructions

Not to scale

Door Thickness: 1 3/8 in [34.9 mm]* to 1 3/4 in [44.5 mm] doors

For other door thicknesses, please contact Customer Service.

*To use the C-60RE and C60RT Flush Pulls on a 1 3/8 in [34.9 mm] thick door, the thru-bolted post on each flush pull are supplied with a notch that allows for shortening its length for 1 3/8 in [34.9 mm] thick doors. Twist off or cut with hack saw.

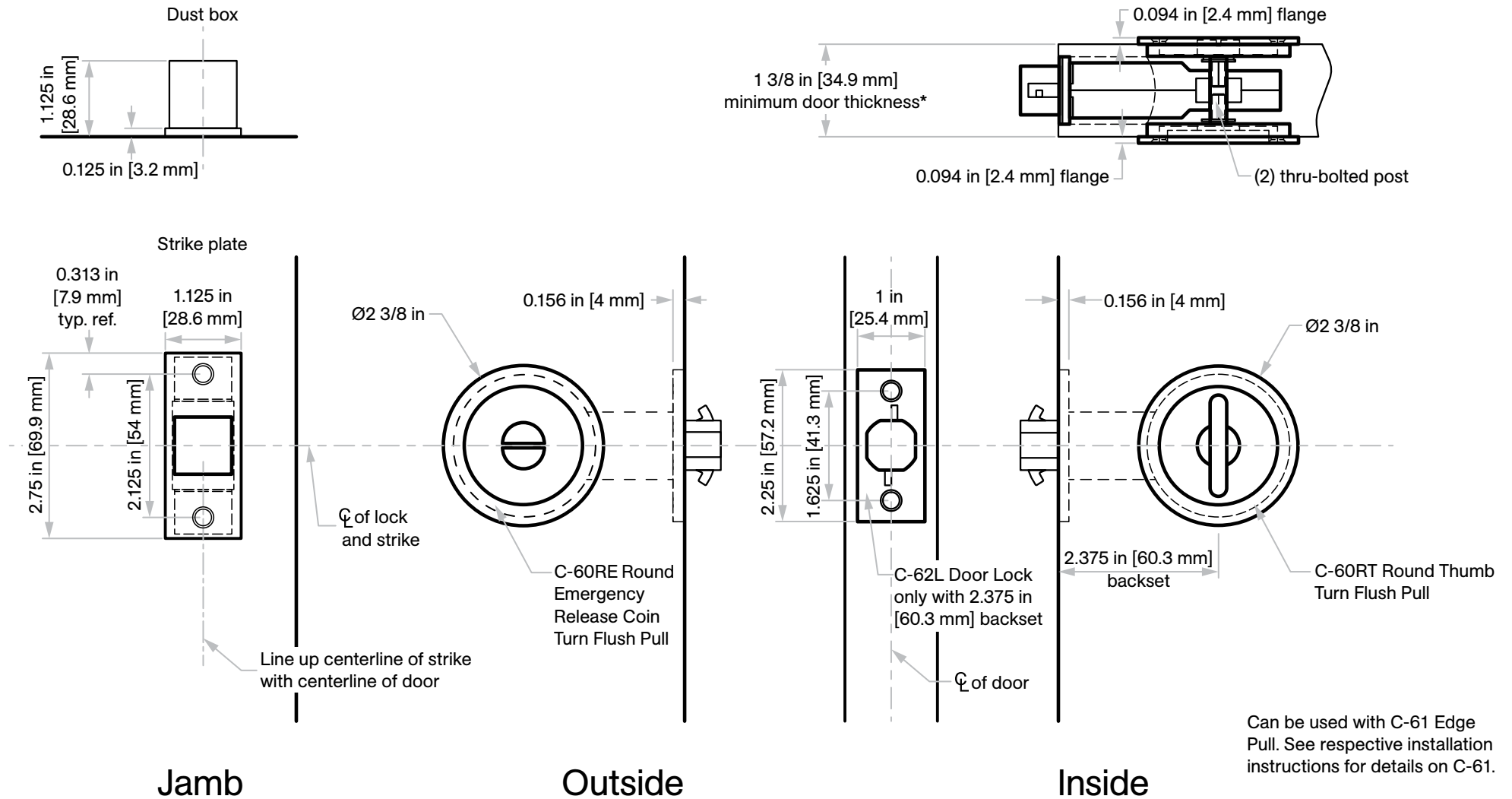

Door Prep Template

Not to scale

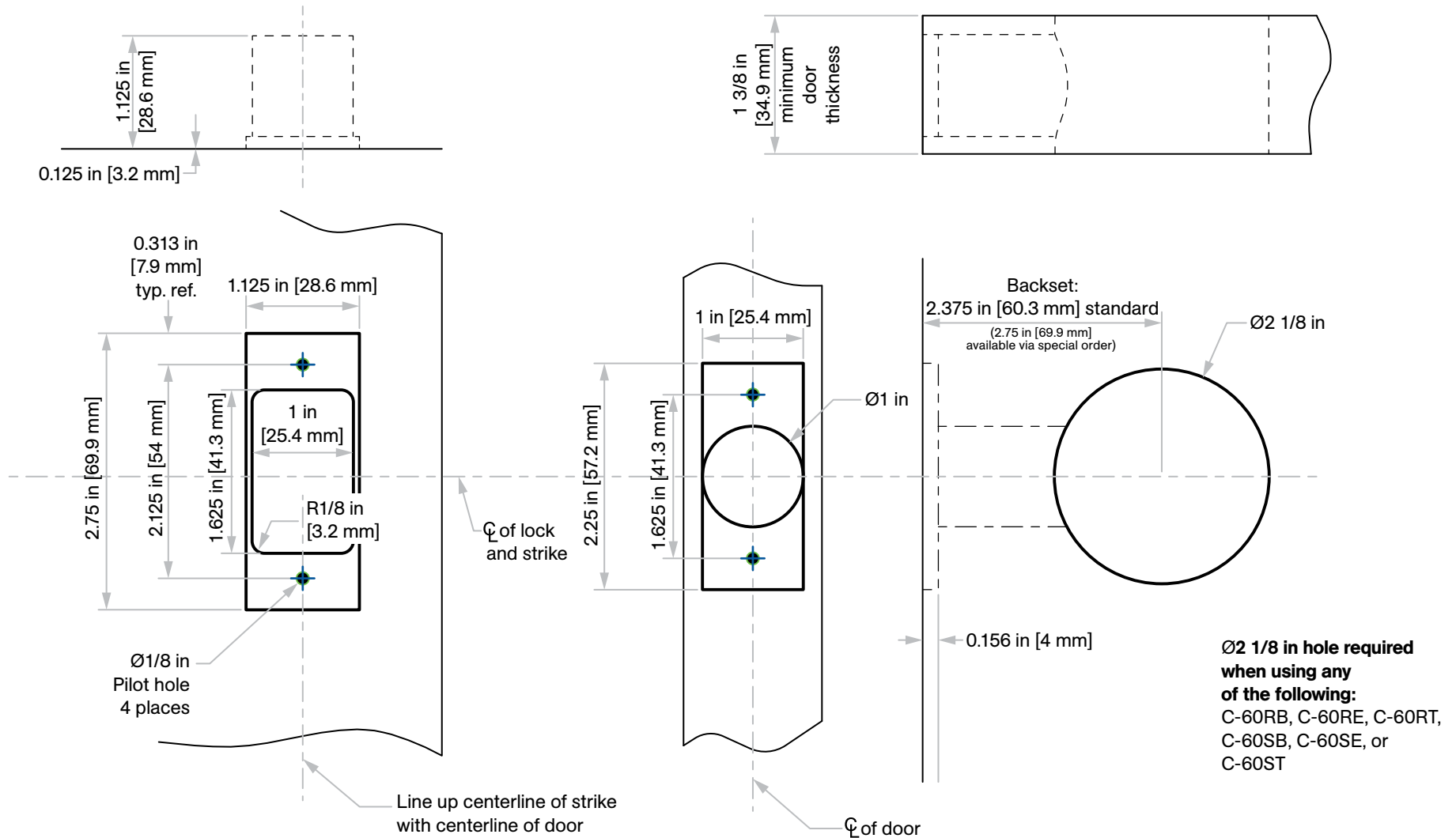

Ø2 1/8 in hole required when using any of the following:
 C-60RB, C-60RE, C-60RT, C-60SB, C-60SE, or C-60ST

Responsibility

Door and frame manufacturers are responsible for providing adequate construction or reinforcement for proper installation of hardware shown.

Installation

Install C-62L Lock Body, strike plate, C-60RE, and C-60RT using twelve (12) #8 screws provided.