

# C-91-BHBH Passage Set

Installation Instructions

**KNC**  
Door Locks & Pulls

## Specifications

**Case:** Heavy gauge wrought

**Armor Front:** Brass, bronze, stainless

**Pull:** 1/2 in [12.7 mm] thick x 2 in [50.8 mm] high x 1 1/4 in [31.8 mm] throw

**Door Thickness:** 1 3/4 in [44.5 mm] minimum

Not to scale

## Included Components

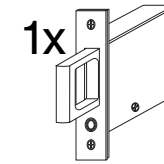

**C-91**  
Edge Pull Body

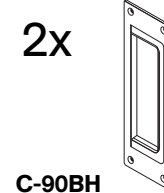

**C-90BH**  
Swing-Out Handle Flush Pull

### Inside of Door

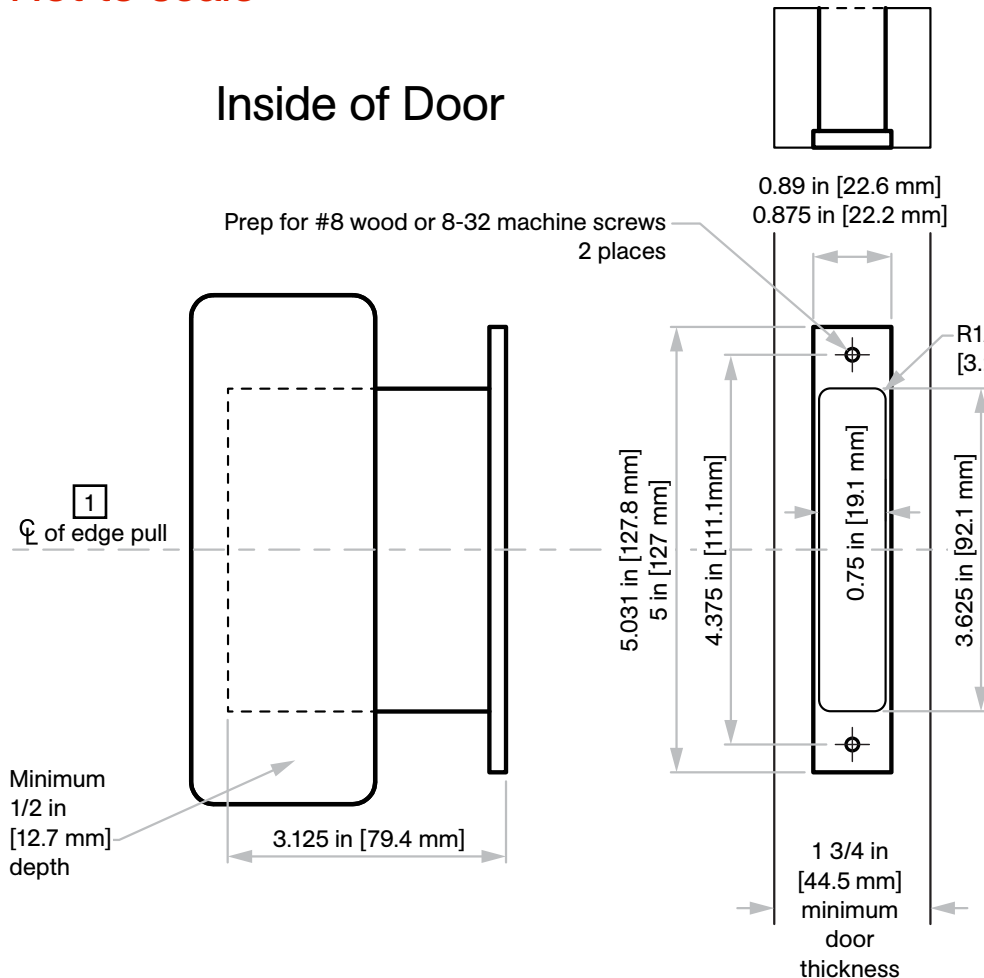

### Outside of Door

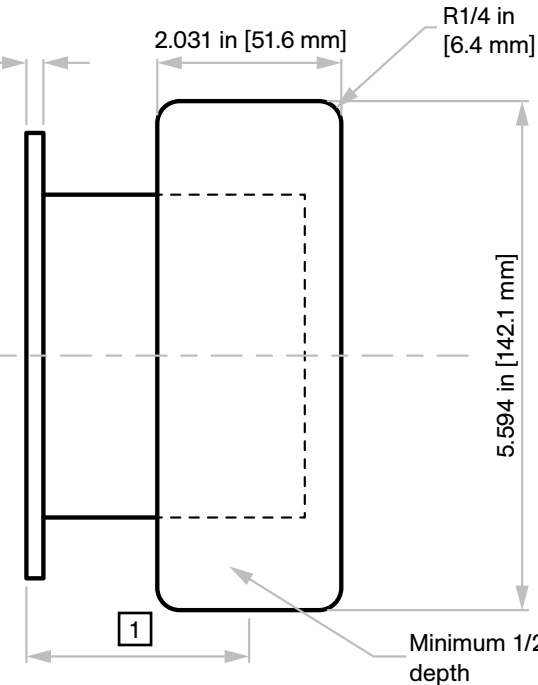

- 1 Horizontal and vertical spacing of the flush pulls is up to the end user. KNC recommends to line up the backset with the other locks on your project. For example: 2 in [50.8 mm], 2.5 in [63.5 mm], 2.75 in [69.8 mm], 5 in [127 mm] and 6 in [152.4 mm]

## Responsibility

Door and frame manufacturers are responsible for providing adequate construction or reinforcement for proper installation of hardware shown.

**KN Crowder**

1220 Burloak Drive, Burlington, Ontario, Canada, L7L 6B3

T. 1-866-999-1562 customerservice@kncrowder.com kncrowder.com

© 2020-2025 K.N. Crowder Mfg. Inc. All Rights Reserved.