

# C-92L-CT Security Lockset

Installation Instructions

## Specifications

**Case:** Heavy gauge wrought

**Armor Front:** Brass, bronze, stainless

**Dead Bolt:** 1/2 in [12.7 mm] thick x 1 7/32 in [31 mm] high x 1 in [25.4 mm] throw

**Thumb Turn Hub:** 3/16 in [4.8 mm] on the diamond

**Cam:** See details on right

**Door Thickness:** 1 3/8 in [34.9 mm] to 2 1/4 in [57.2 mm]

## Cam Required: B520-233

### Dimensions

W = 1.000 in [25.4 mm]

X = 0.232 in [5.9 mm]

Y = 0.729 in [18.5 mm]

Z = 0.694 in [17.6 mm]

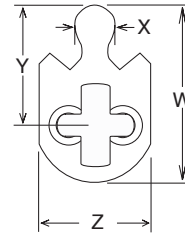

## Included Components

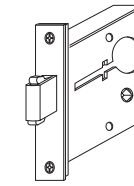

**C-92L**  
Lock Body

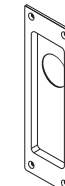

**C-90C**  
Cylinder  
Flush Pull



**C-90T**  
Thumb Slide  
Flush Pull



**Cylinder**  
1-5/32 in Diameter  
hole x 1 in Depth.  
5-PIN Schlage "C"  
Key Way (will **not**  
sit flush with door)

## Not to scale

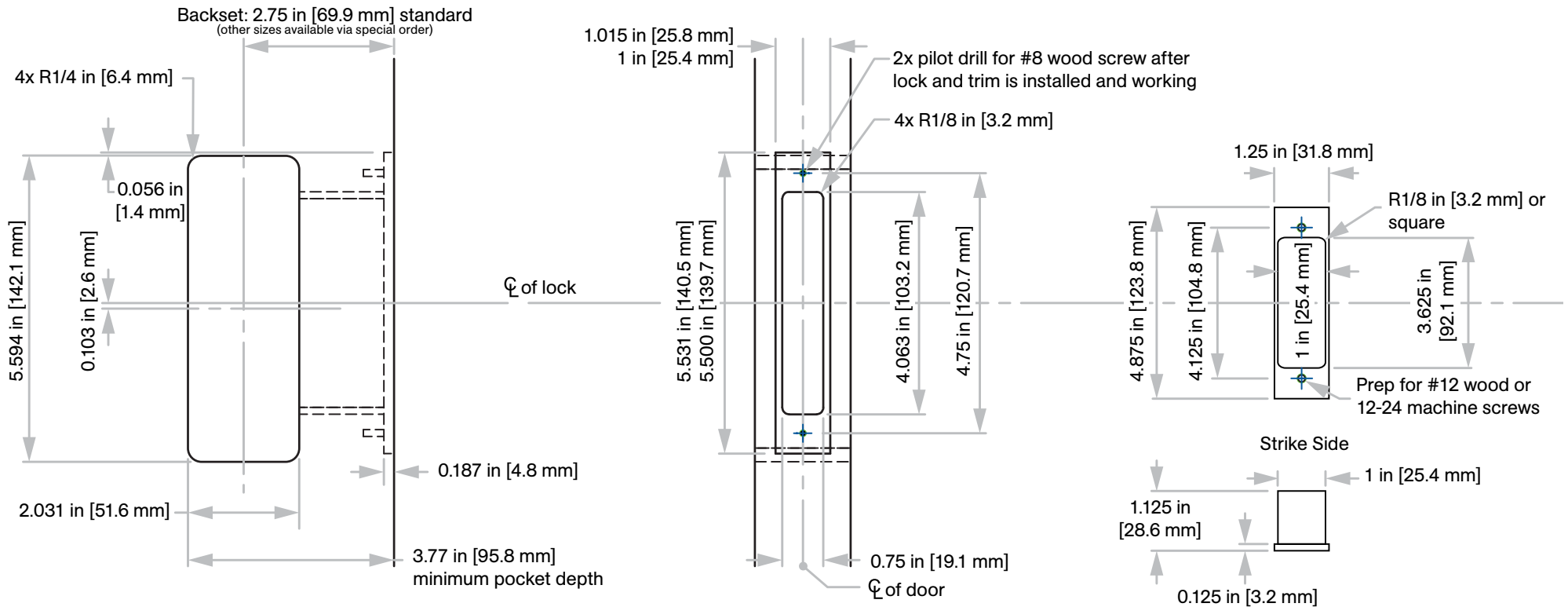

**Note:** Cylinder will **not** sit flush with 1 3/8 in [34.9 mm] doors.