

C-94BL-CT Security Lockset

Installation Instructions

Specifications

Case: Heavy gauge wrought
Armor Front: Brass, bronze, stainless
Cam: See details on right
Door Thickness: 1 3/4 in [44.5 mm]

Note: Cylinder will **not** sit flush with 1 3/8 in [34.9 mm] doors.

Cam Required: B520-233

Dimensions
W = 1.000 in [25.4 mm]
X = 0.232 in [5.9 mm]
Y = 0.729 in [18.5 mm]
Z = 0.694 in [17.6 mm]

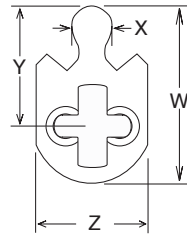

Included Components

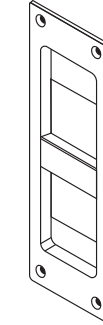
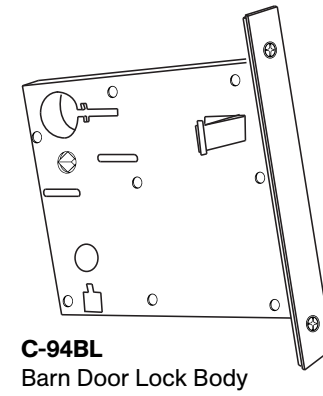

Cylinder
1-5/32 in Diameter hole x 1 in Depth.
5-PIN Schlage "C" Key Way (will **not** sit flush with door)

Not to scale

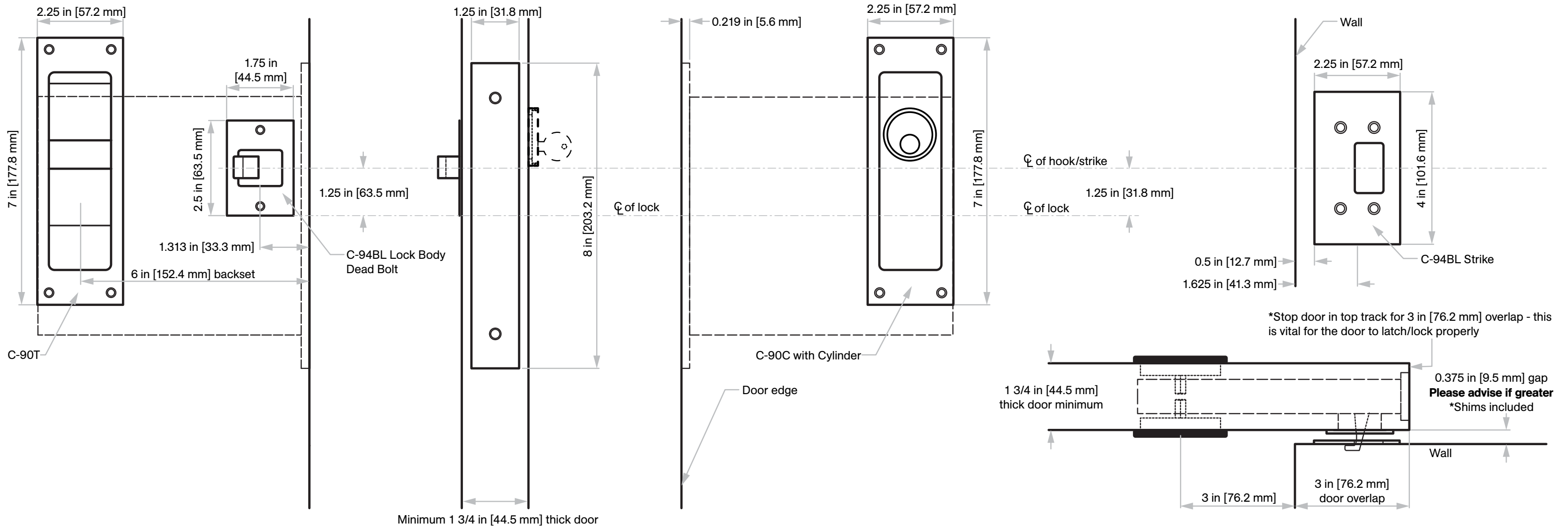

Note: Door size = opening width plus 6 in [152.4 mm]
Example: 40 in [1016 mm] opening + 6 in [152.4 mm] = 46 in [1168.4 mm] wide door

Strike Kit

Supplied Standard

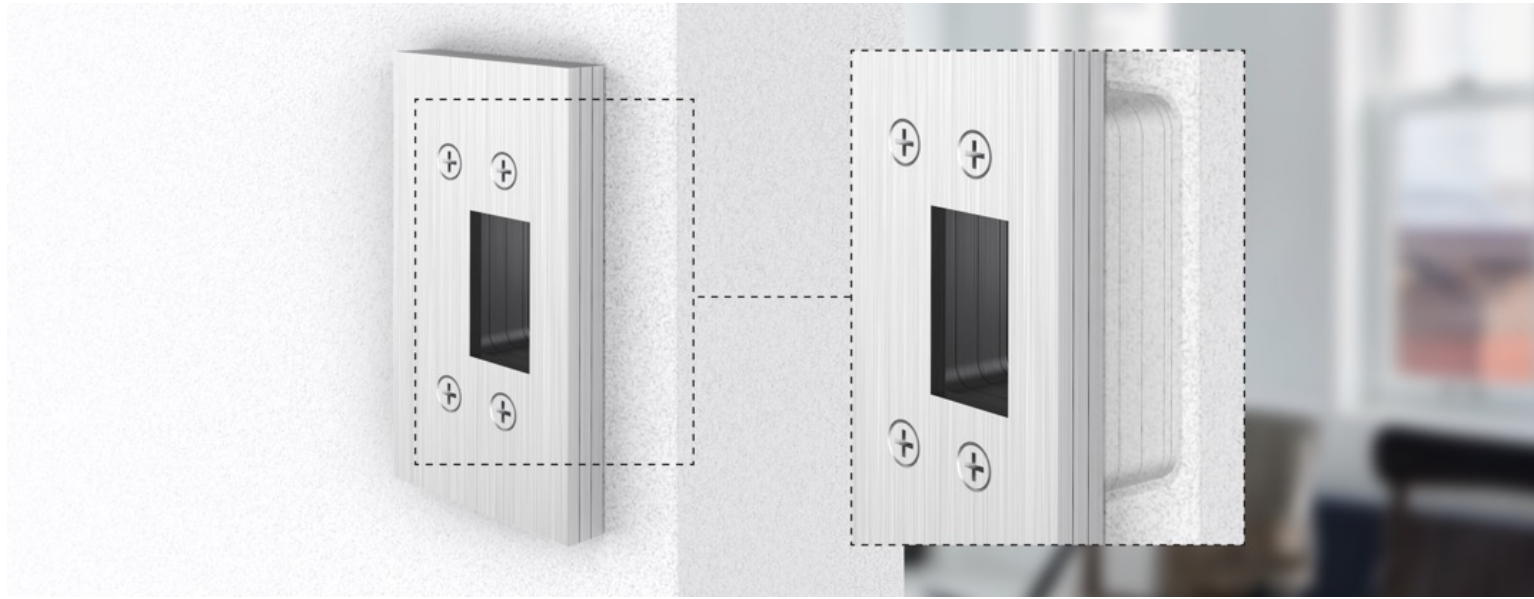

Not to scale

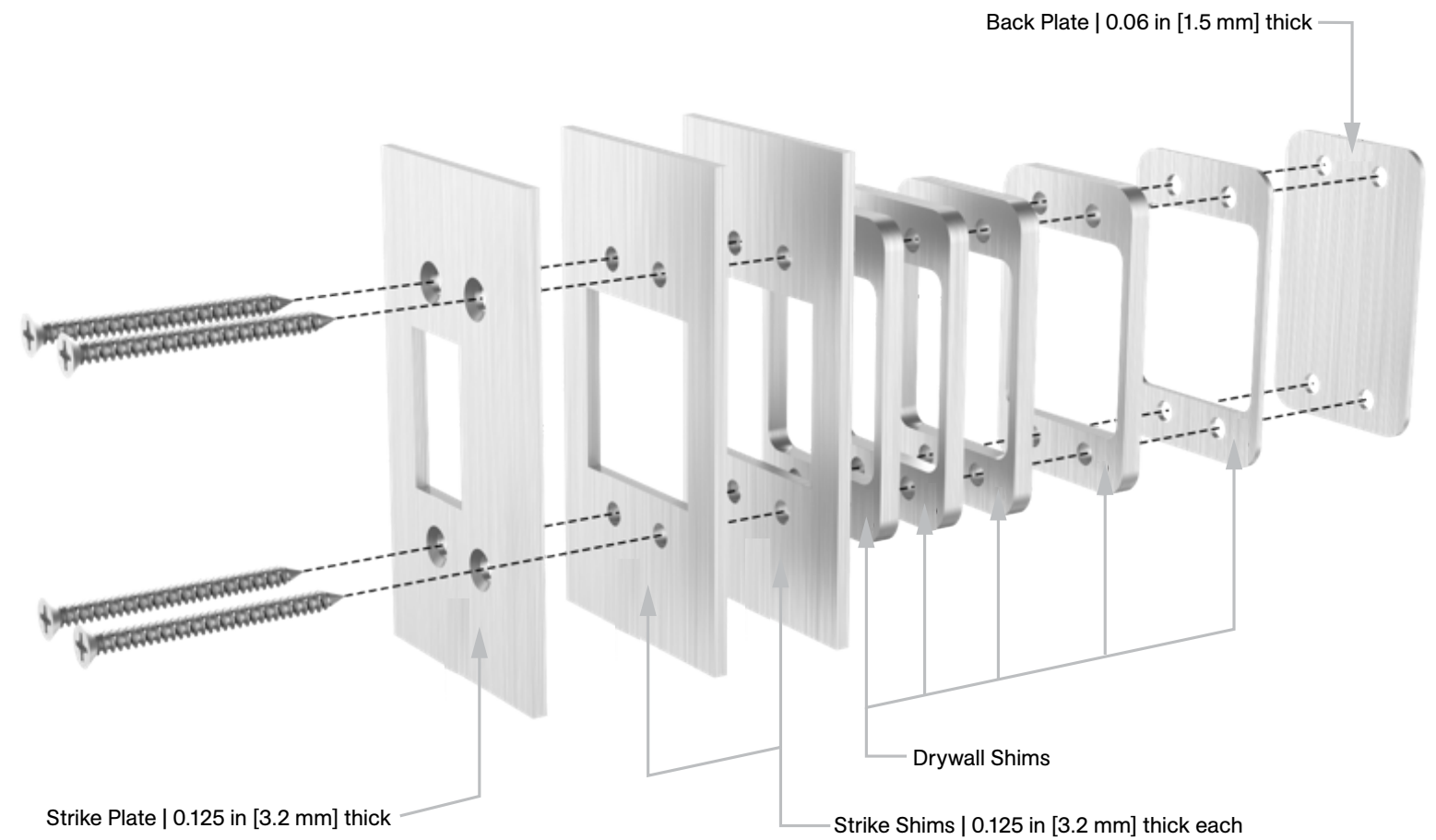
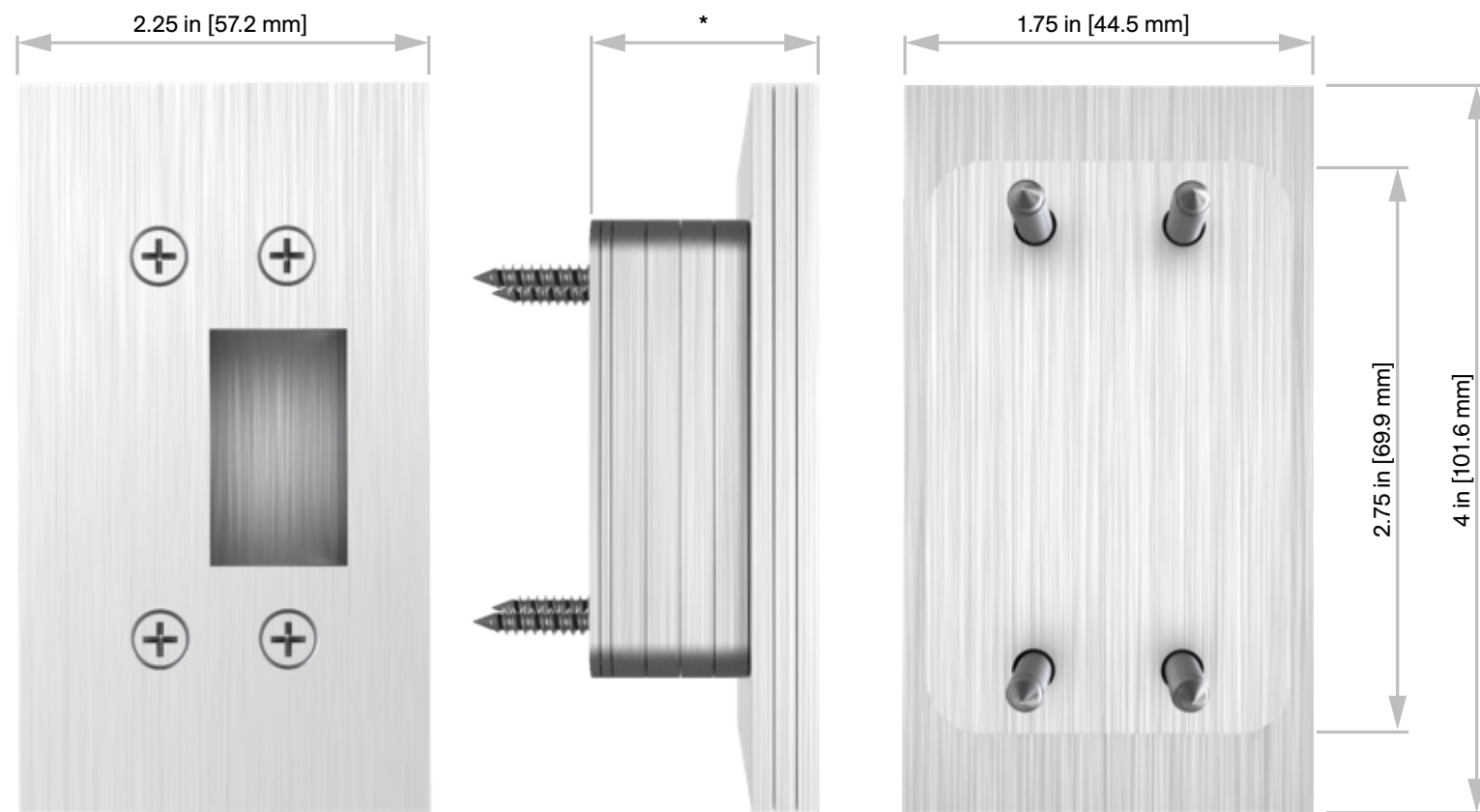

Number of drywall shims used is a function of drywall thickness.

Number of strike shims used is a function of the gap between the face of the door and the wall.