

Installation Instructions

For 1 3/4 in [44.4 mm] thick doors only

Note: Door size = opening width plus 6 in [152.4 mm]

Example: 40 in [1016 mm] opening + 6 in [152.4 mm] = 46 in [1168.4 mm] wide door

C-94BL
Barn Door Lock Body

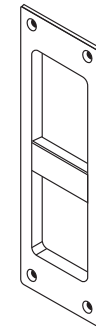

C-90E
Flip Cover Emergency Access Flush Pull

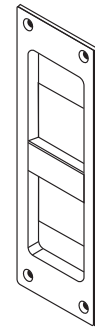

C-90T
Thumb Slide Flush Pull

Not to scale

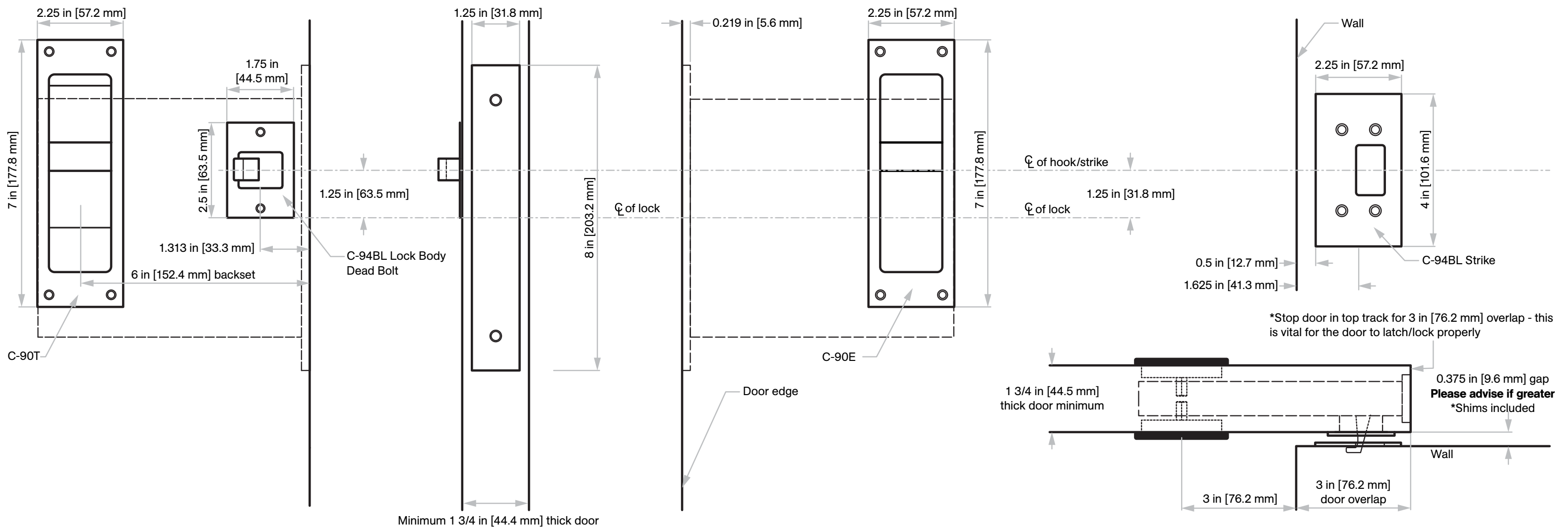

Door Prep Template

Not to scale

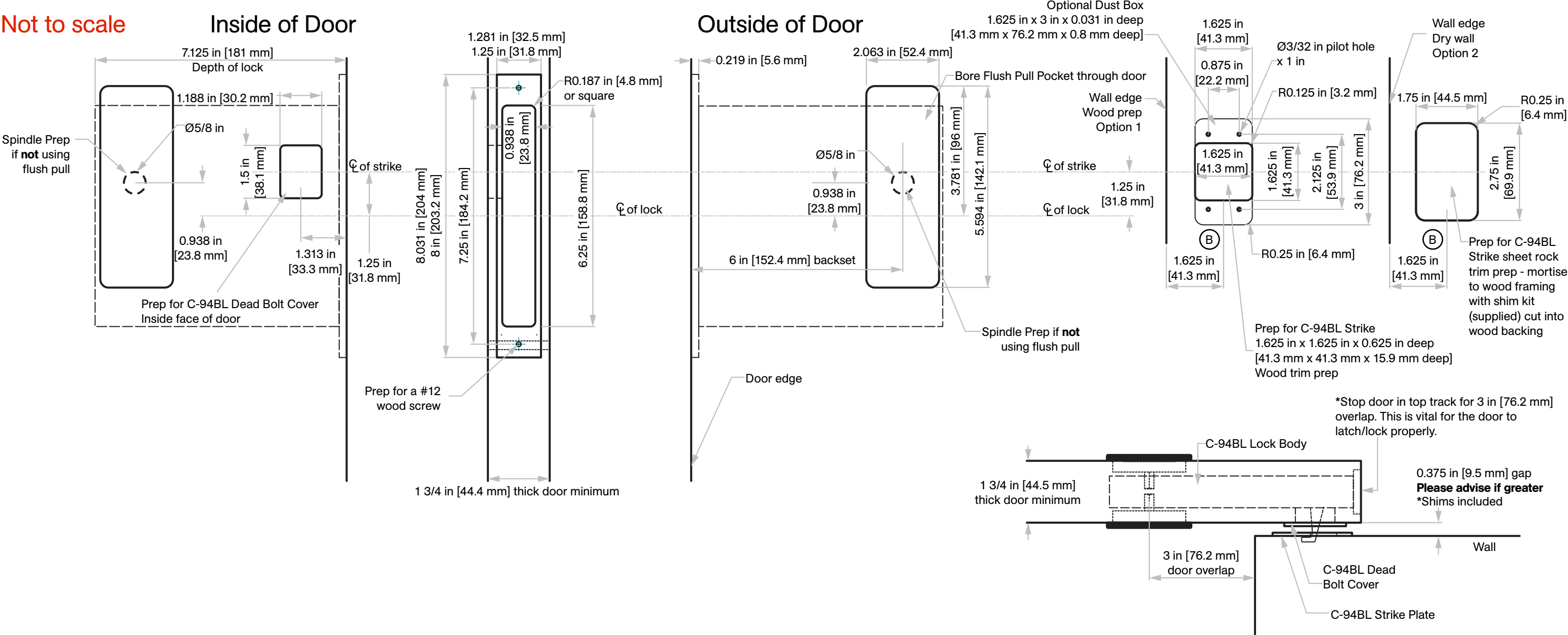

Expose Screws
Rotate thumb turn 90 degrees to project bolt and expose the two bolt screws



Remove Bolt from Lock Body
Extend the bolt and loosen screws without removing them and remove bolt assembly from the lock



Insert Lock into Door
Insert lock into door
Loosen insert mounting screws



Reattach Bolt
Slightly rotate loose thumb turn to make lock body screws visible
Reinstall bolt assembly by aligning screw holes
Tighten screws
Use thumb turn to fit bolt assembly back in

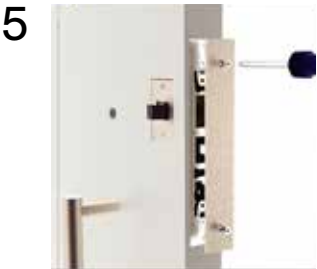

Install Armour Front
Secure lock in door by tightening screws into door
Install armour front onto basefront



Mount Cuff
Mount the bolt cuff aligning per template
Install trim accordingly

Strike Kit

Supplied Standard

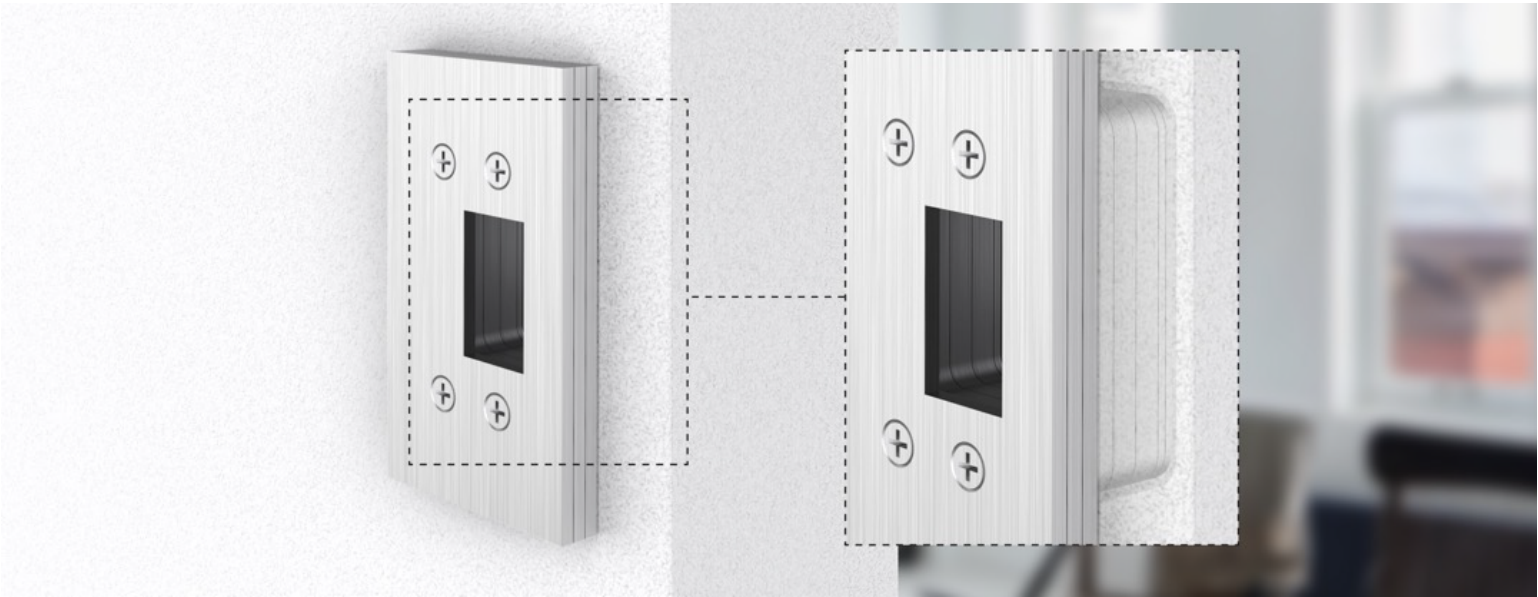

Not to scale

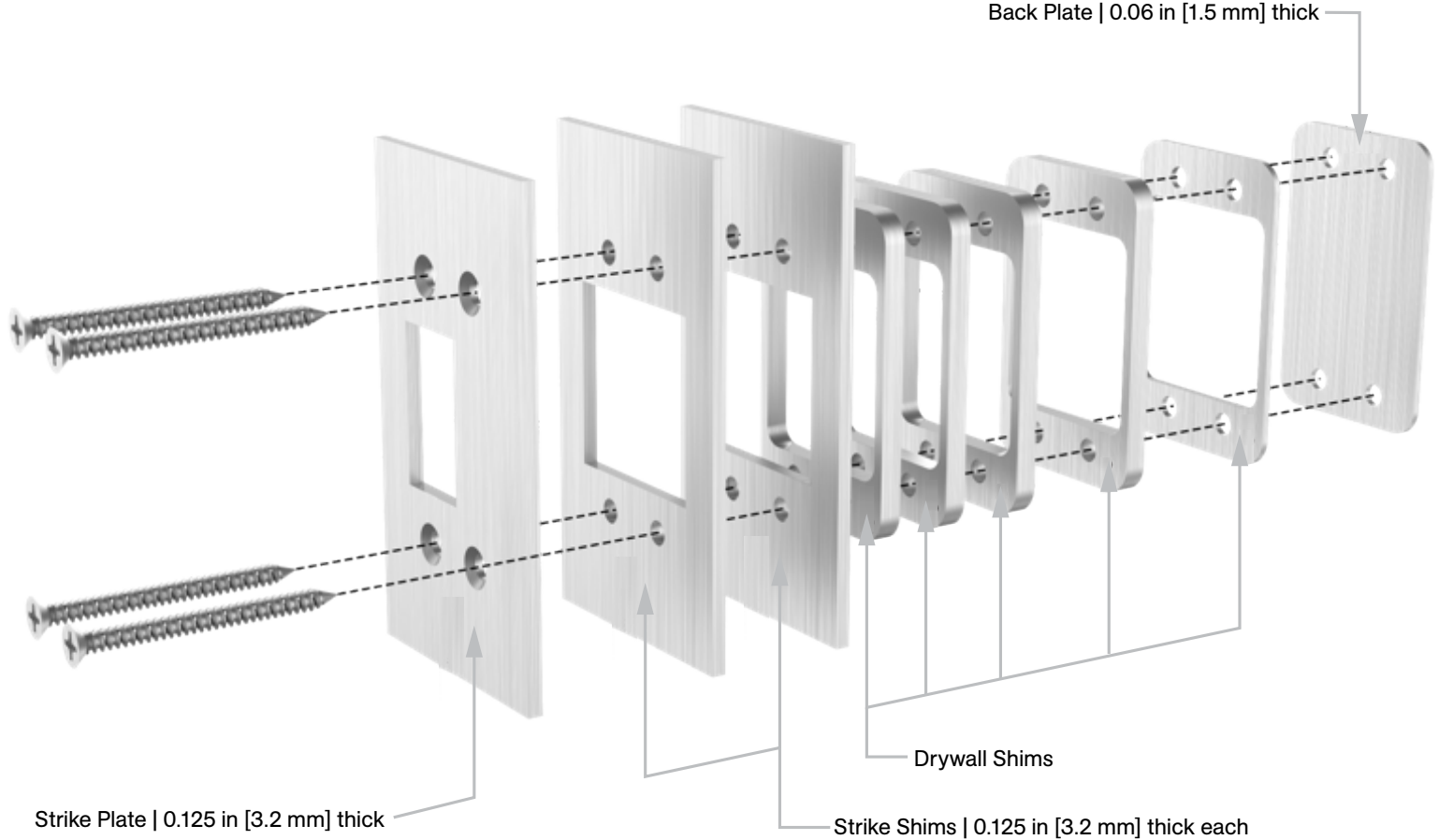
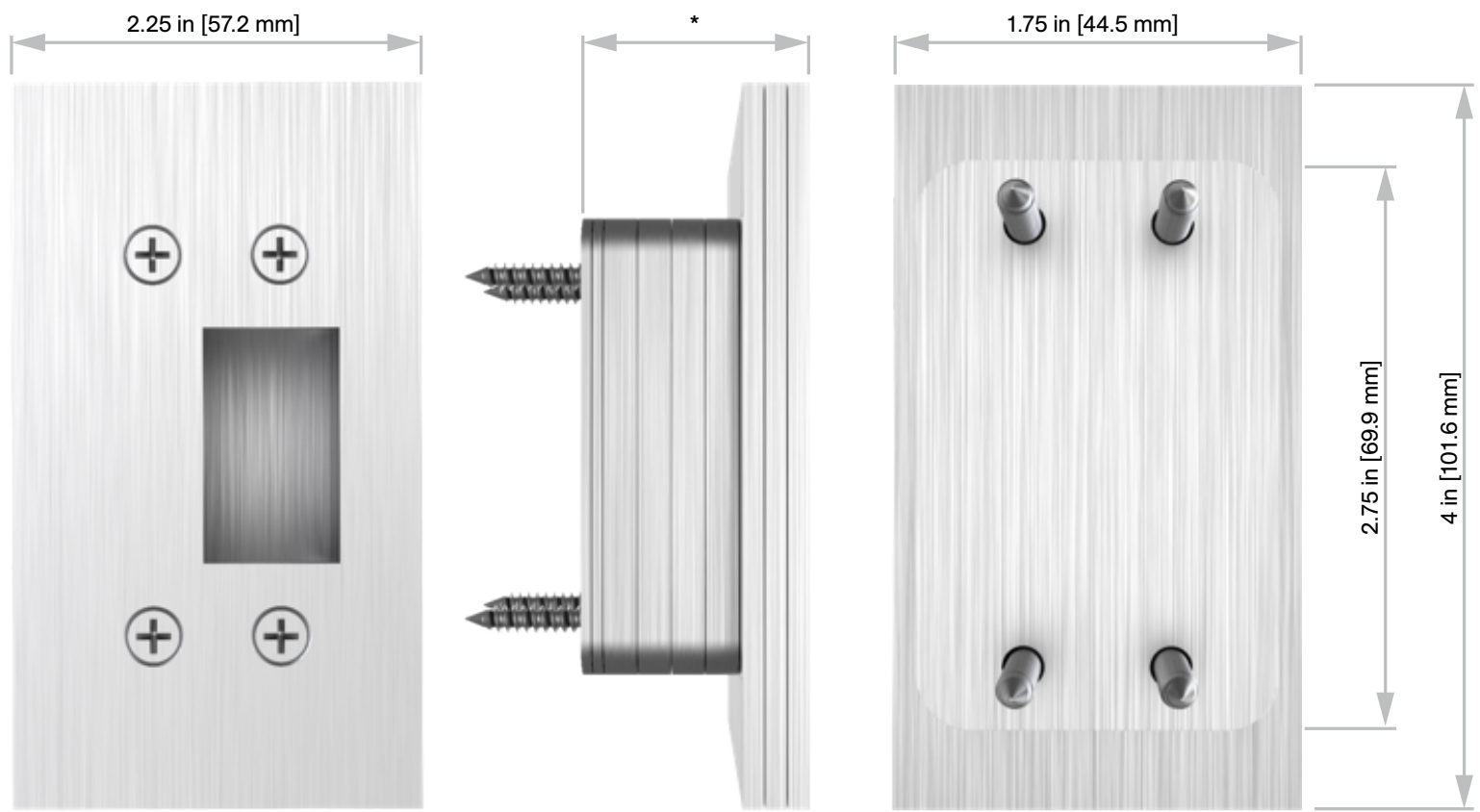

Number of drywall shims used is a function of drywall thickness.

Number of strike shims used is a function of the gap between the face of the door and the wall.