

# C-94BL-OT Privacy Lockset

Installation Instructions

For 1 3/4 in [44.4 mm] thick doors only

**Note:** Door size = opening width plus 6 in [152.4 mm]  
Example: 40 in [1016 mm] opening + 6 in [152.4 mm] = 46 in [1168.4 mm] wide door

## Components Included:

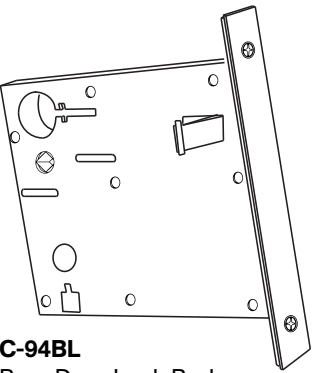

**C-94BL**  
Barn Door Lock Body



**C-900I**  
Occupancy Indicator with Coin Turn Flush Pull

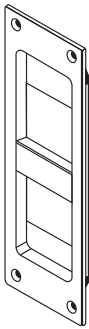

**C-90TS**  
Thumb Slide Flush Pull with Short Spindle

Not to scale

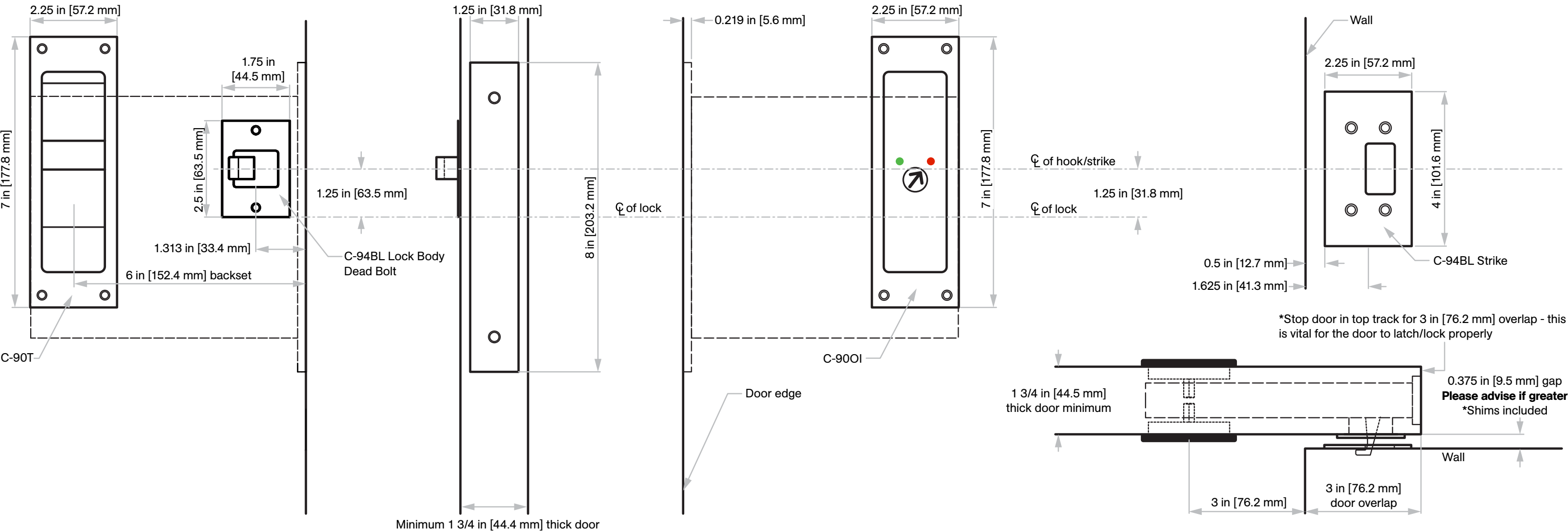

# Door Prep Template

Not to scale

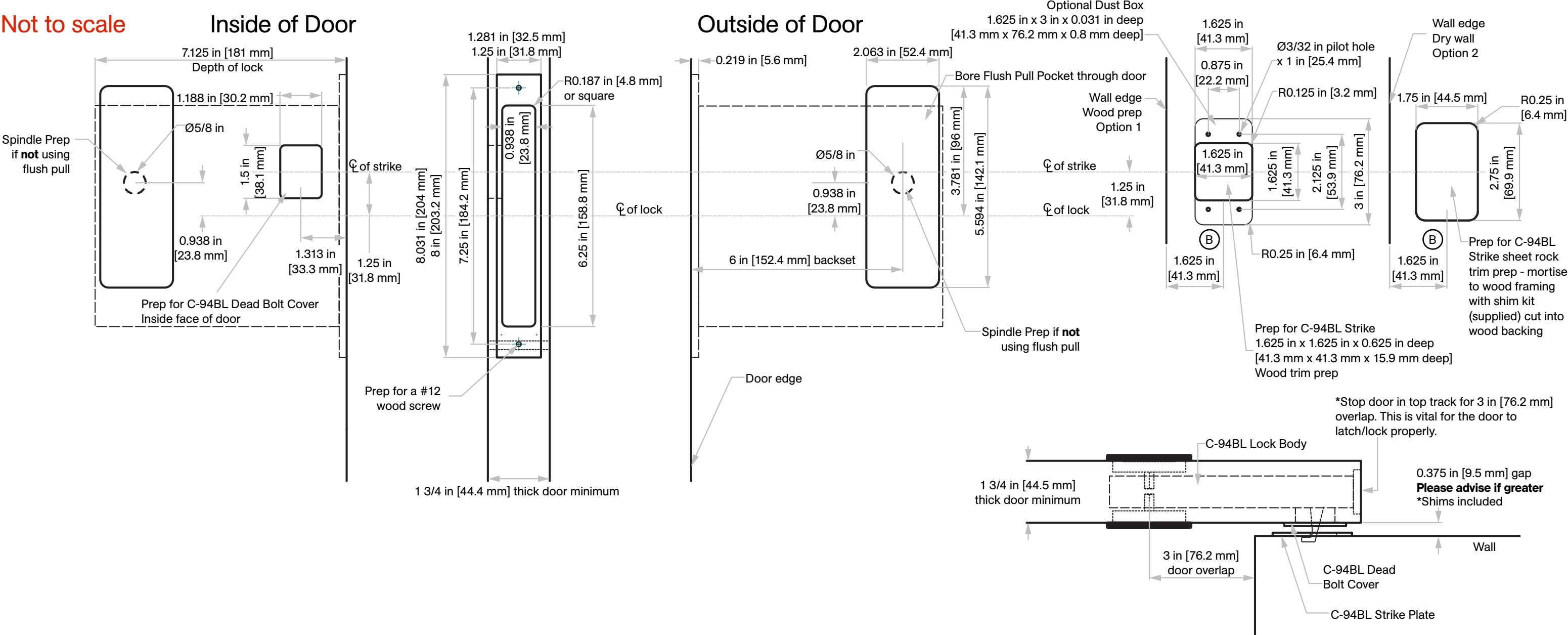

**Expose Screws**  
Rotate thumb turn 90 degrees to project bolt and expose the two bolt screws



**Remove Bolt from Lock Body**  
Extend the bolt and loosen screws without removing them and remove bolt assembly from the lock



**Insert Lock into Door**  
Insert lock into door  
Loosen insert mounting screws



**Reattach Bolt**  
Slightly rotate loose thumb turn to make lock body screws visible  
Reinstall bolt assembly by aligning screw holes  
Tighten screws  
Use thumb turn to fit bolt assembly back in

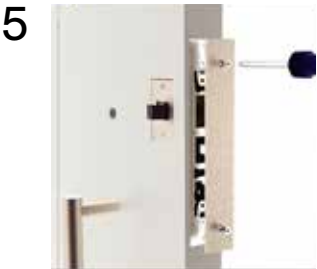

**Install Armour Front**  
Secure lock in door by tightening screws into door  
Install armour front onto basefront



**Mount Cuff**  
Mount the bolt cuff aligning per template  
Install trim accordingly

# Strike Kit

Supplied Standard

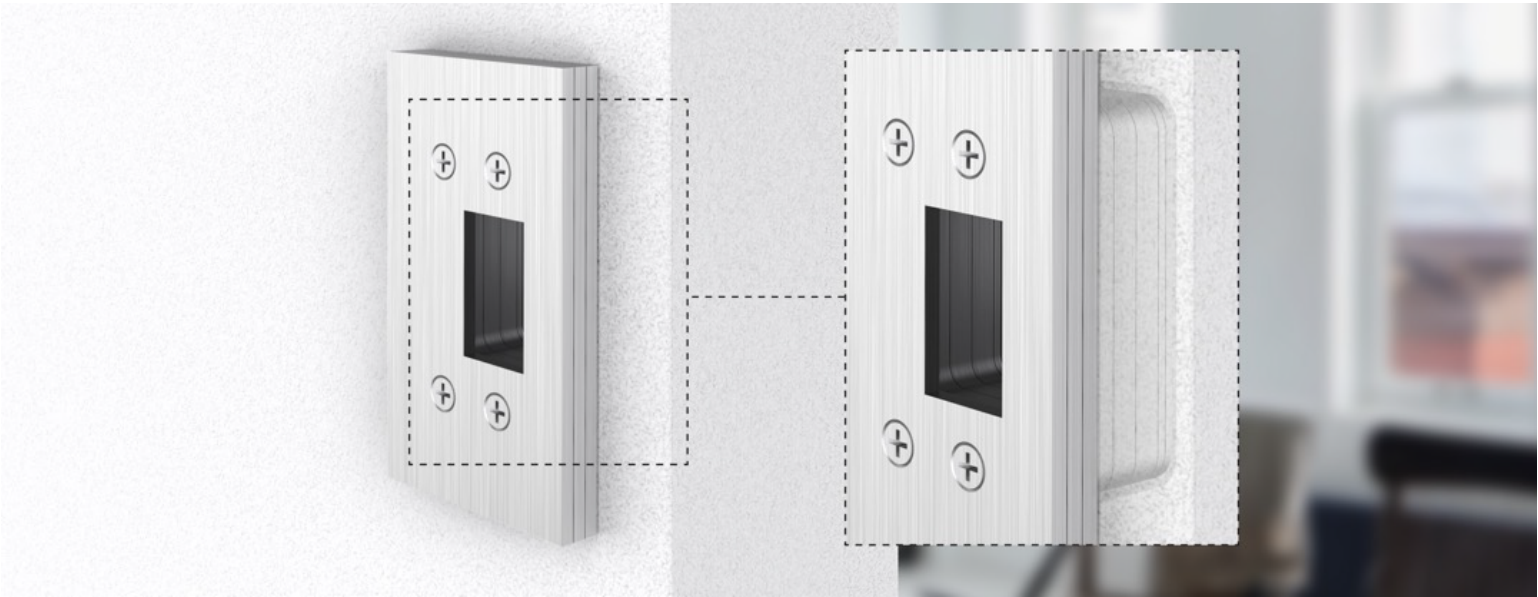

Not to scale

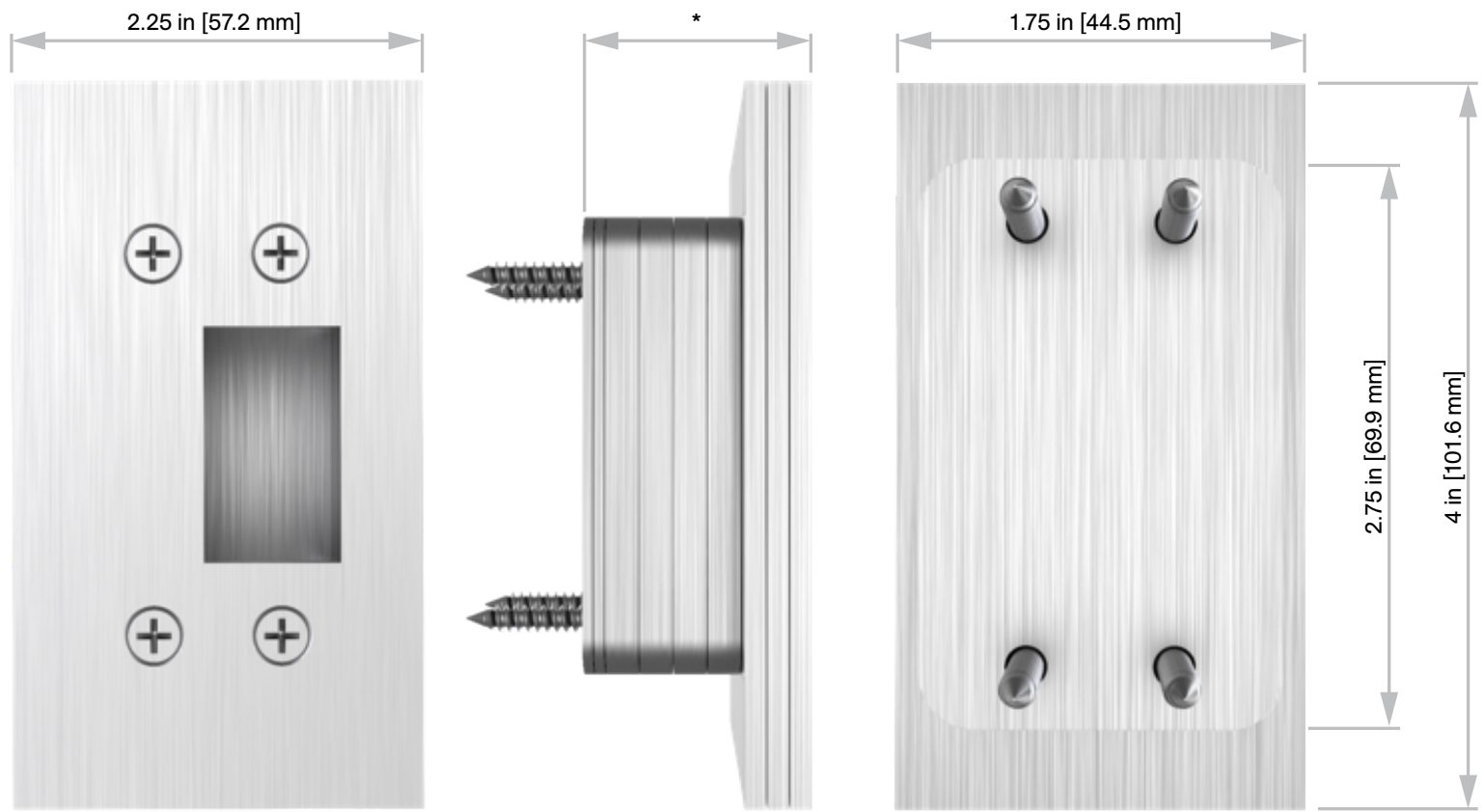

Number of drywall shims used is a function of drywall thickness.  
Number of strike shims used is a function of the gap between the face of the door and the wall.

