

# C-95SL-CHL Security Lockset & Pulls

## Self-Latching Barrier-Free (ADA Compliant)

Installation Instructions

**KNC**  
Door Locks & Pulls

### Specifications:

**Case:** Heavy gauge wrought

**Armor Front:** Brass, bronze, stainless

**Dead Bolt:** 1/2 in [12.7 mm] thick x 5/8 in [15.9 mm] high x 1 in [25.4 mm] throw

**Pull:** 1/4 in [6.4 mm] thick x 1 1/2 in [38.1 mm] high x 7/8 in [22.2 mm] swingout

**Cam:** See details of cam required for cylinders used with C-95SL lock

### Cam Required: B520-233

Dimensions

W = 1.000 in [25.4 mm]

X = 0.232 in [5.9 mm]

Y = 0.729 in [18.5 mm]

Z = 0.694 in [17.6 mm]

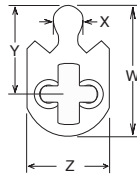

### Components Included:

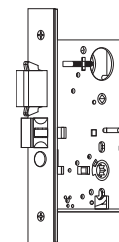

**C-95ESL**  
Entry  
Self-Latching  
Lock Body

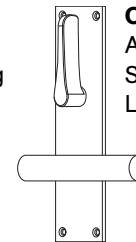

**C-95TL**  
ADA Turn  
Self-Latching  
Lever Trim

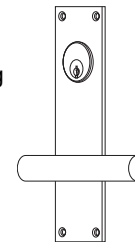

**C-95CL**  
Cylinder  
Self-Latching  
Lever Trim

**Cylinder**  
1 in diameter  
hole x 1 in  
depth. 5-PIN  
Schlage "C"  
Key Way (will  
sit flush with  
door)



**Suitable for 1 3/4 in [44.5 mm] thick doors only**

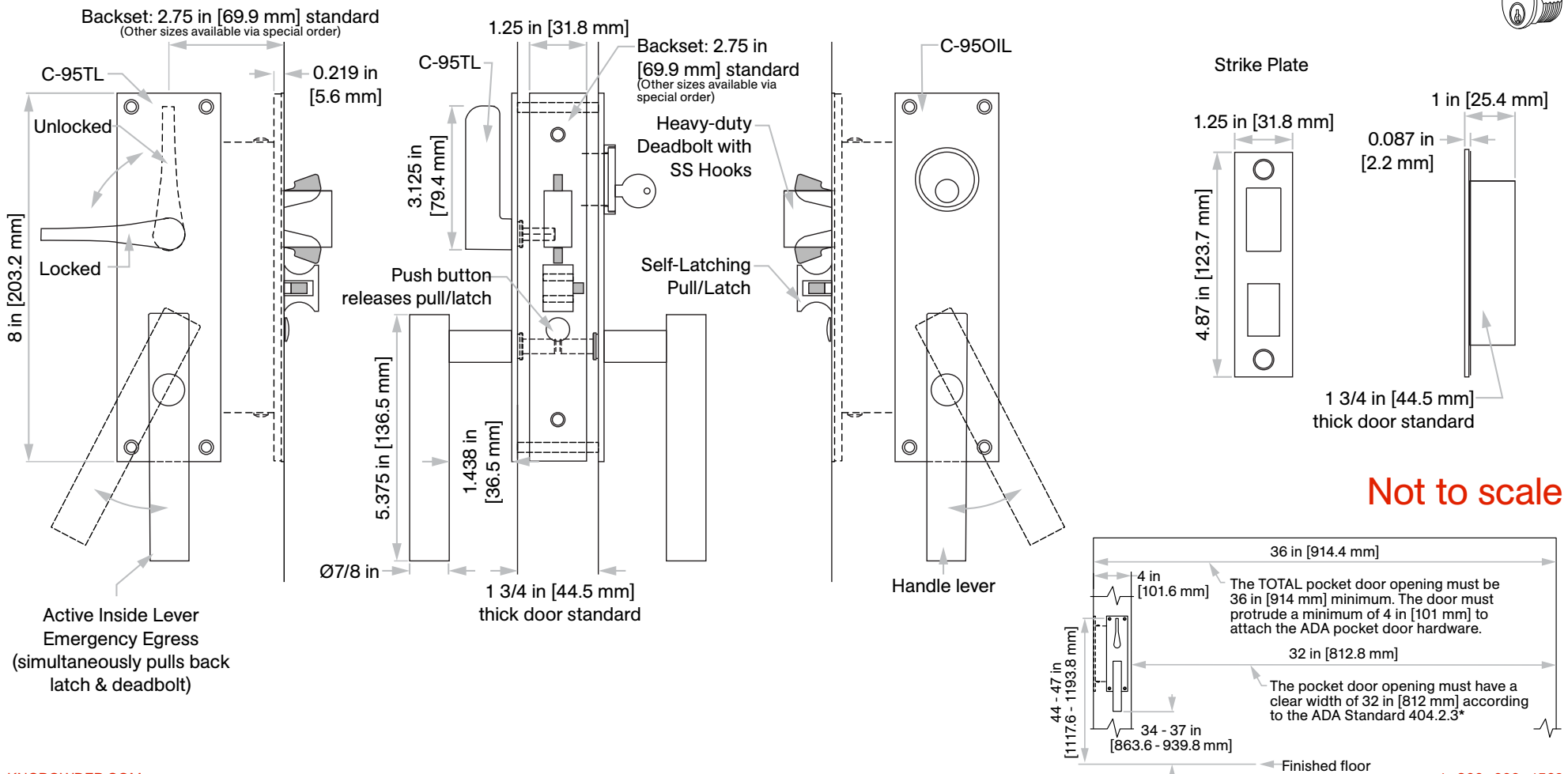

# Door Prep Template

Not to scale

- 1 Insert backset here 2.5 in [63.5 mm], 2.75 in [69.9 mm], 5 in [127 mm], or 6 in [152.4 mm], optional sizes available
- 2 Prep for #12 wood or 12-24 machine screws
- 3 Centerline of strike is 0.375 in [9.5 mm] above centerline of lock

## Inside of door

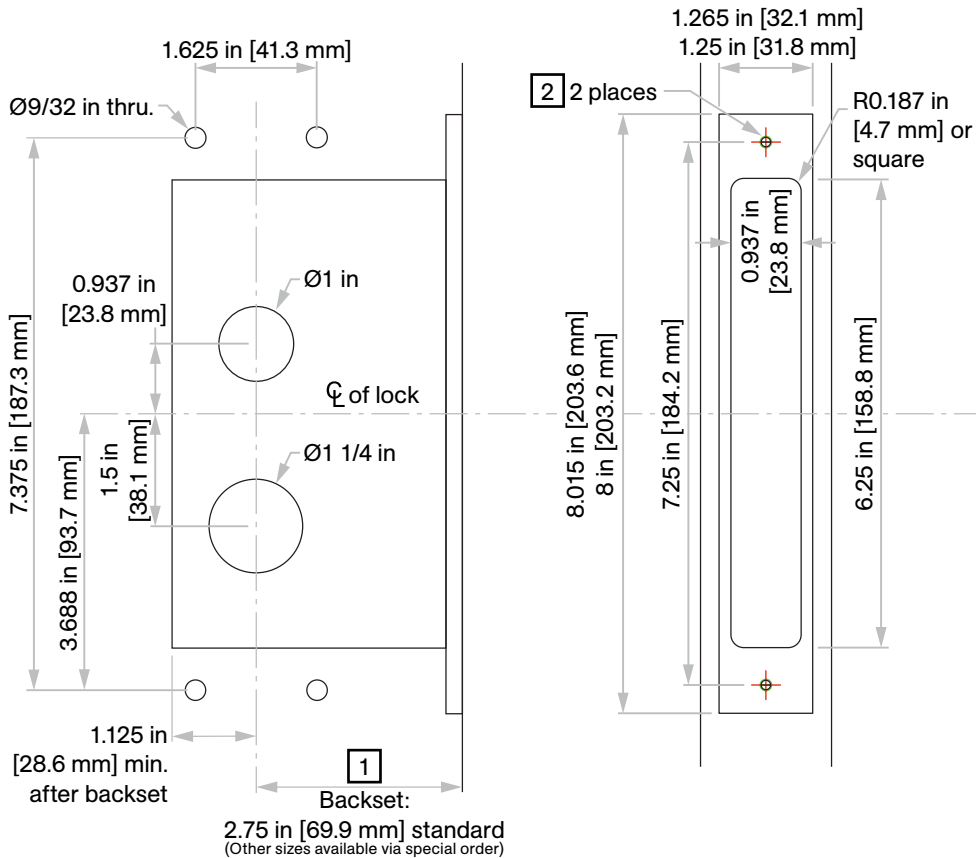

## Outside of door

