

C-95SL-CT Security Lockset

Self-Latching Flush

Installation Instructions

Specifications

Case: Heavy gauge wrought

Armor Front: Brass, bronze, stainless

Dead Bolt: 1/2 in [12.7 mm] thick x 5/8 in [15.9 mm] high x 1 in [25.4 mm] throw

Cam: See details on right

Door Thickness: 1 3/4 in [44.5 mm]

Cam Required: B520-233

Dimensions

W = 1.000 in [25.4 mm]

X = 0.232 in [5.9 mm]

Y = 0.729 in [18.5 mm]

Z = 0.694 in [17.6 mm]

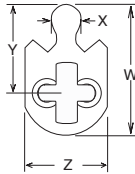

Not to scale

Included Components

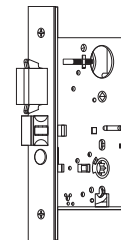

C-95ESL
Entry
Self-Latching
Lock and
Edge Pull
Body

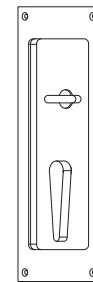

C-95TFP
Thumb Turn
Self-Latching
Flush Pull

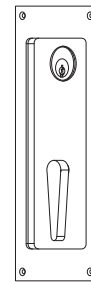

C-95CFP
Cylinder
Self-Latching
Flush Pull

Cylinder
1-5/32 in
Diameter Hole
x 1 in depth.
5-PIN Schlage
"C" Key Way
(will **not** sit
flush with
door)



Inside of Door

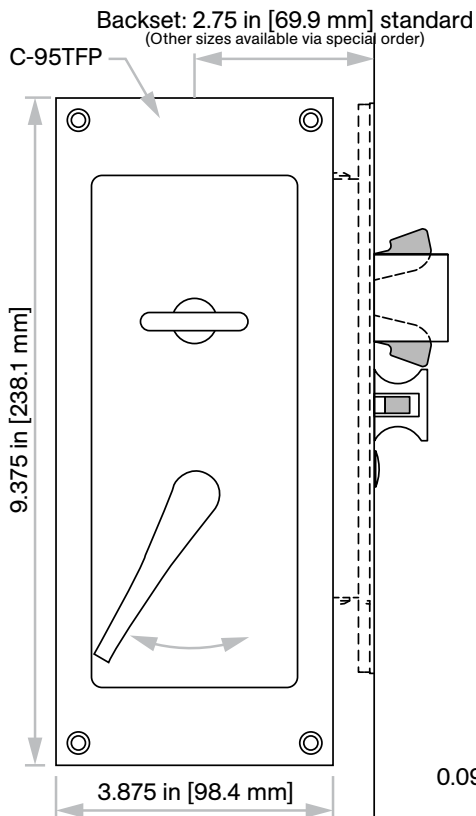

Outside of Door

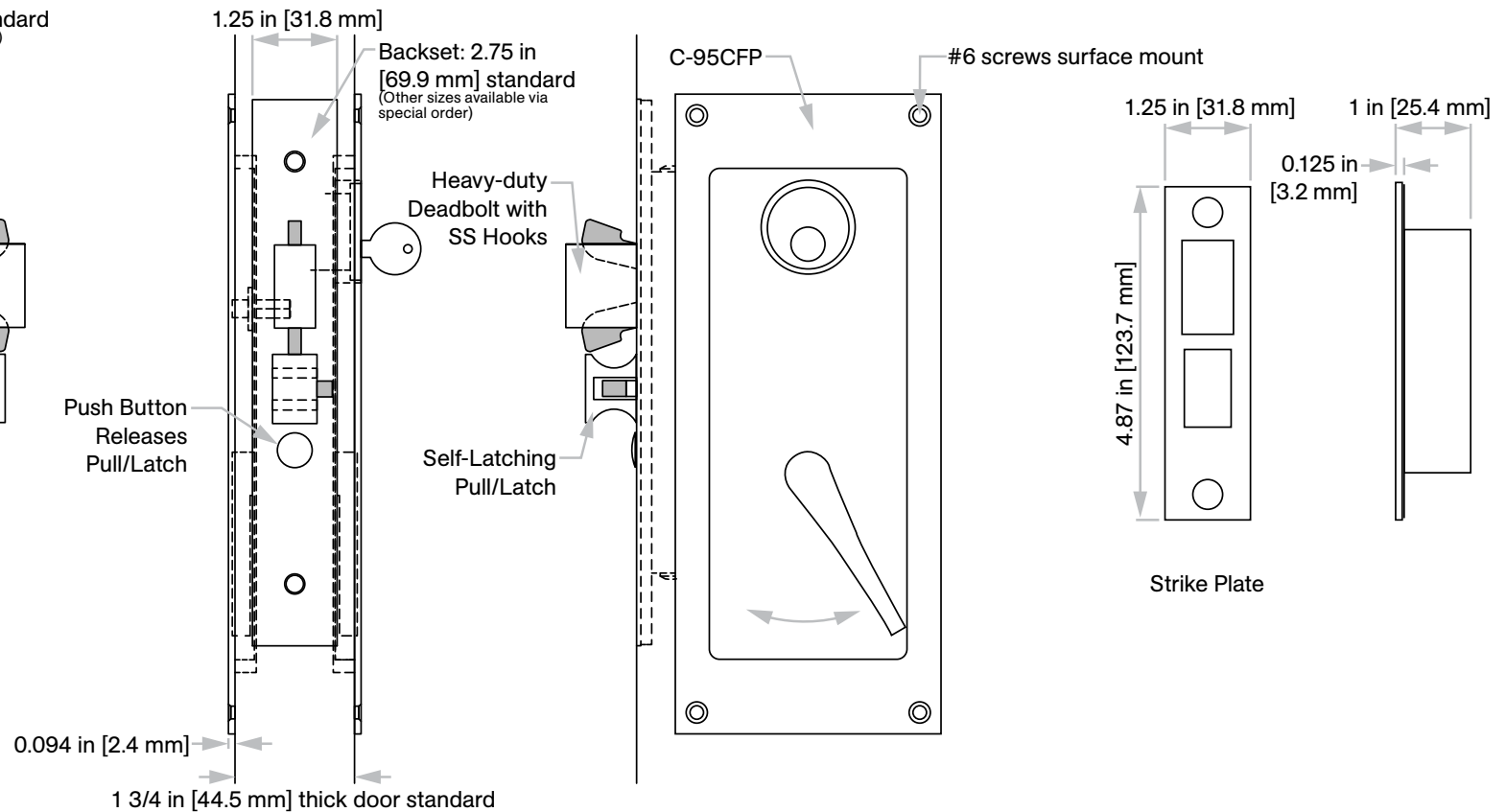

Door Prep Template

Not to scale

- 1 Insert backset here 2.5 in [63.5 mm], 2.75 in [69.9 mm], 5 in [127 mm], or 6 in [152.4 mm], optional sizes available
- 2 Prep for #12 wood or 12-24 machine screws
- 3 Centerline of strike is 0.375 in [9.5 mm] above centerline of lock

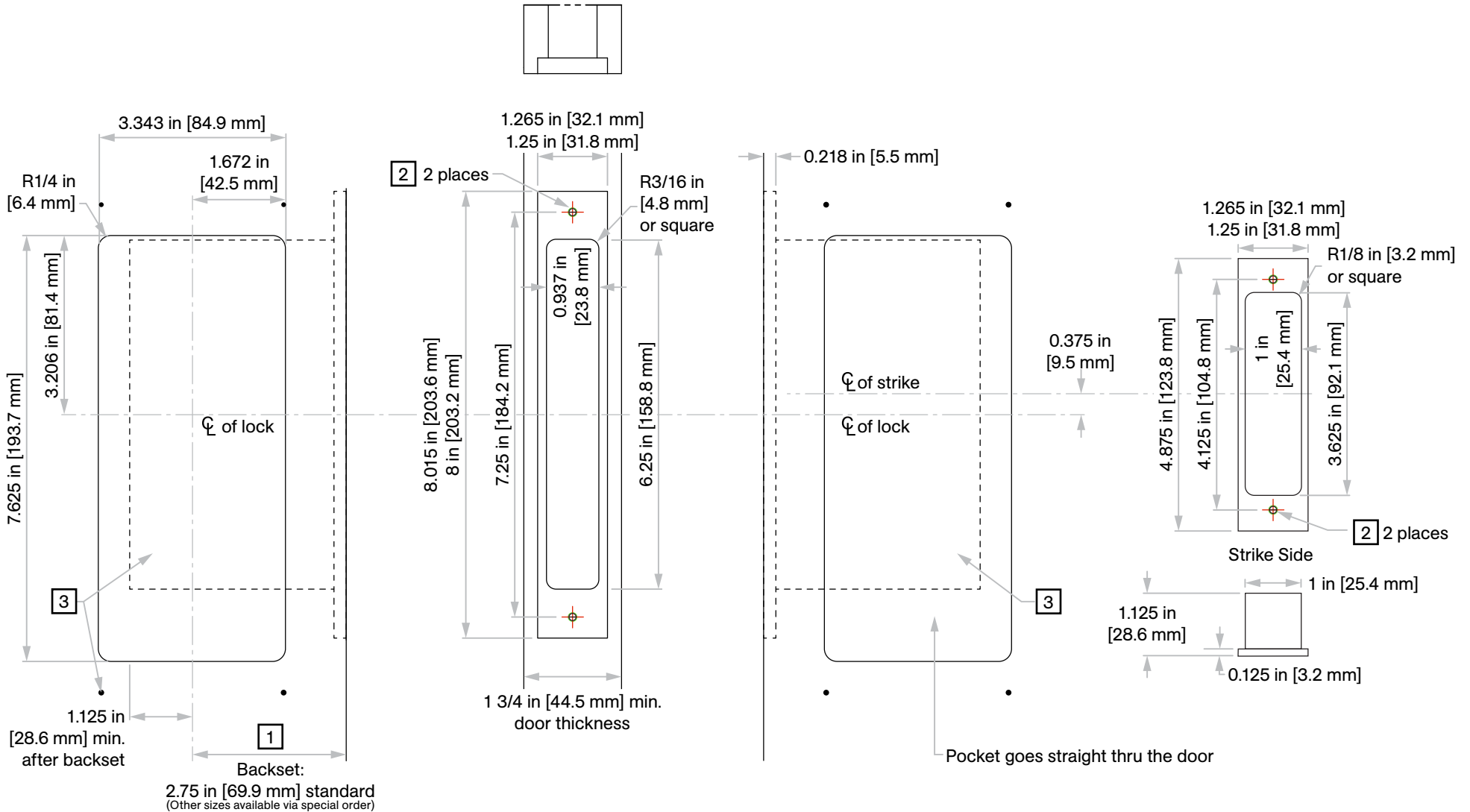

KN Crowder

1220 Burloak Drive, Burlington, Ontario, Canada, L7L 6B3
 T. 1-866-999-1562 customerservice@kncrowder.com kncrowder.com
 © 2020-2025 K.N. Crowder Mfg. Inc. All Rights Reserved.