

# CDL

## Installation Instructions

KNC

### Aluminum Door Louver

For 1 3/8 in [34.9 mm] to 1 3/4 in [44.5 mm] doors

## Parts List

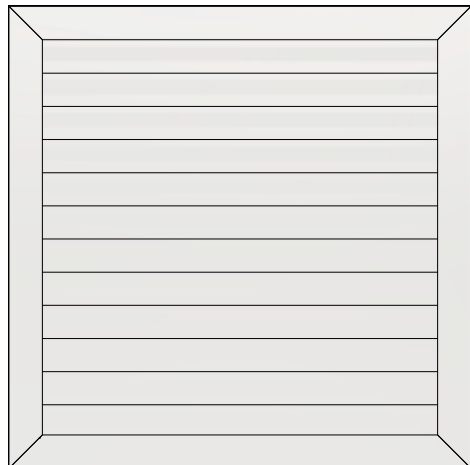

CDL Louver

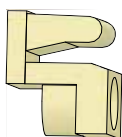

CDL Clips



#6 x 1-1/2" Robertson Flat Head Screws [FT1]

## Optional Add-on Products

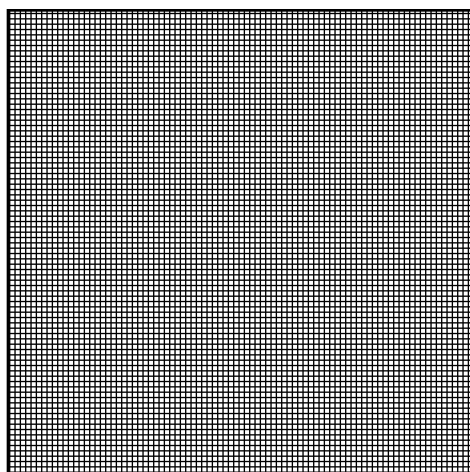

Insect Screen or Bird Screen

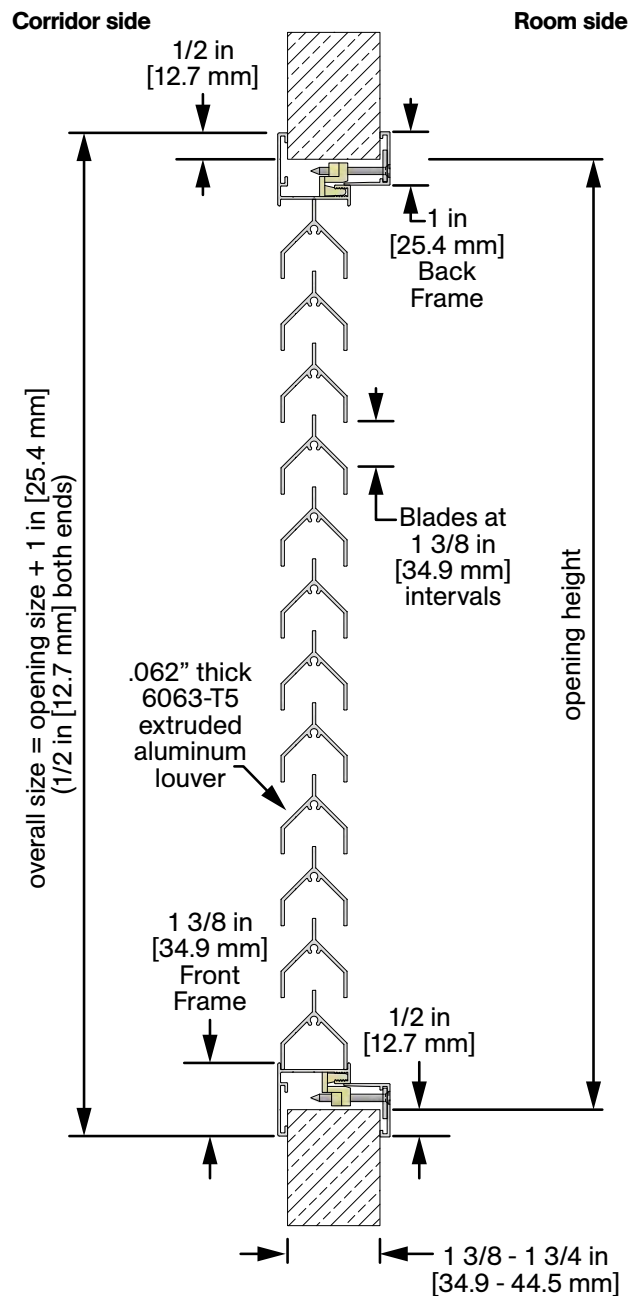

# Installation Steps

## Step #1:

Cut a plumb and square hole in door based on cut-out size of louver.

**Note: Standard CDL order sizes may not be equal to cut-out sizes. Review prior to ordering and cutting hole in door.**

## Step #2:

Insert corridor half of louver into cut-out.

## Step #3:

Insert room half of louver into cut-out and match holes in louver to clips. Secure louver with minimum four (4) #6 x 1-1/2" Flat Head Screws [FT1], alternating in a criss-cross pattern to ensure equal pressure applied. Large louvers may have more screws supplied.

**Note: Do not overtighten as it may deflect frame.**

