

CP-TK-2X4

Installation Instructions

KNC
Catch 'N' Close

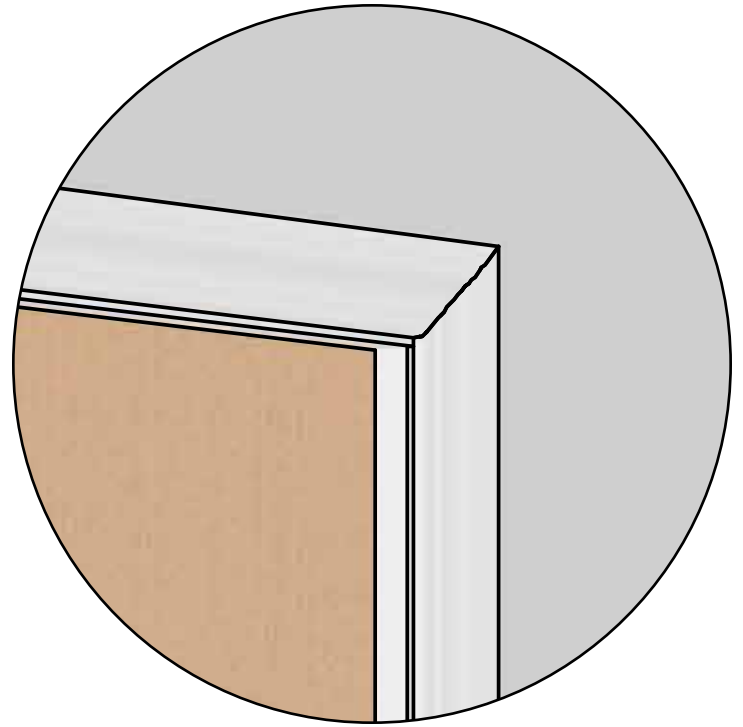
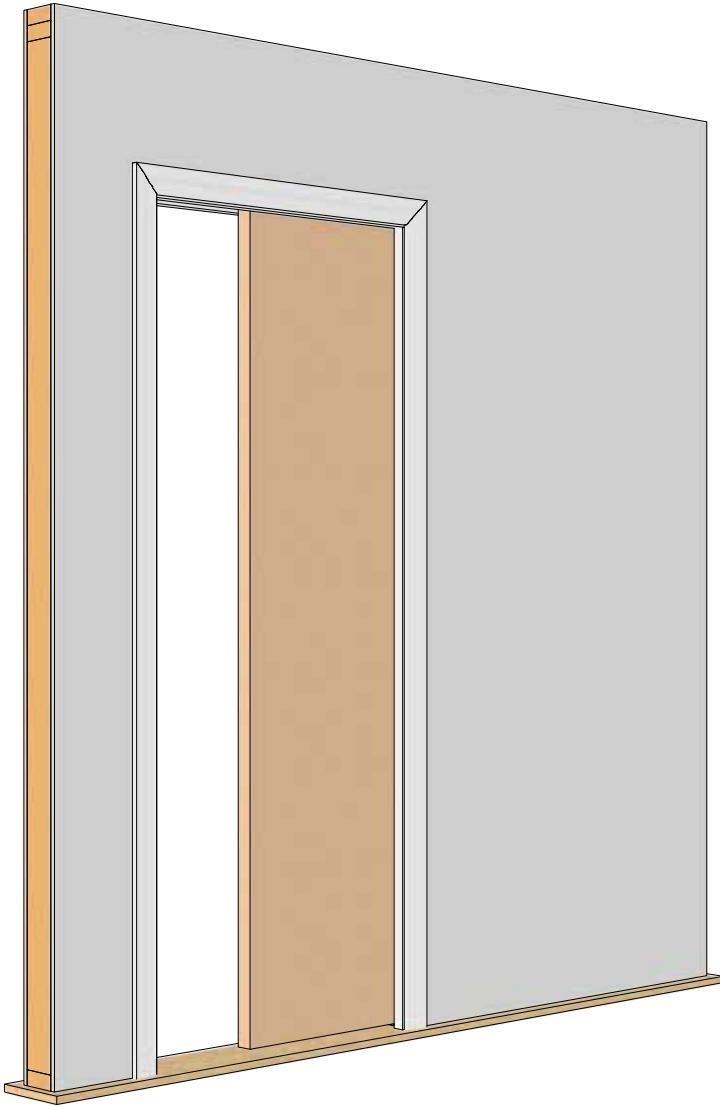

Complete Type CC-W Kit with CP-TK-2X4 Trim Kit illustrated.

Pocket Trim Kit

- The CP-TK Pocket Trim Kit saves on installation time, easy to install and makes easy to remove for pocket door maintenance versus traditional wood trim finishing
- Installing CP-TK Pocket Trim Kit with the Type CC-W Catch 'N' Close Crowder Frame pocket door kit will allow you to install door after drywall is installed which is not possible with traditional pocket door kits. It is recommended to install door for positioning before drywall and then remove it before drywall installation if desired
- Use with 1/2 in [12.7 mm drywall only by others
- For use in 2x4 wall construction only by others
- For use with 1 3/4 in [44.5 mm] thick doors
- To be used with Type CC-W Catch 'N' Close Crowder Frame pocket door kits only
- CP-TK-C2X4 is extruded aluminum, 6061-T6 alloy
- CP-TK-TA2X4 and CP-TK-TC2X4 extrusions are clear anodized
- CP-TK-TA2X4 Inside Trim Covers and C-917 Guide Channel are comes with pile inserts to help cut sound and light transfer through opening
- Can be primed and painted on-site
- Contact customer service for custom finishes

Shown with Type CC-W and C-917 with CP-913 Guide System

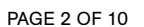

Plan View

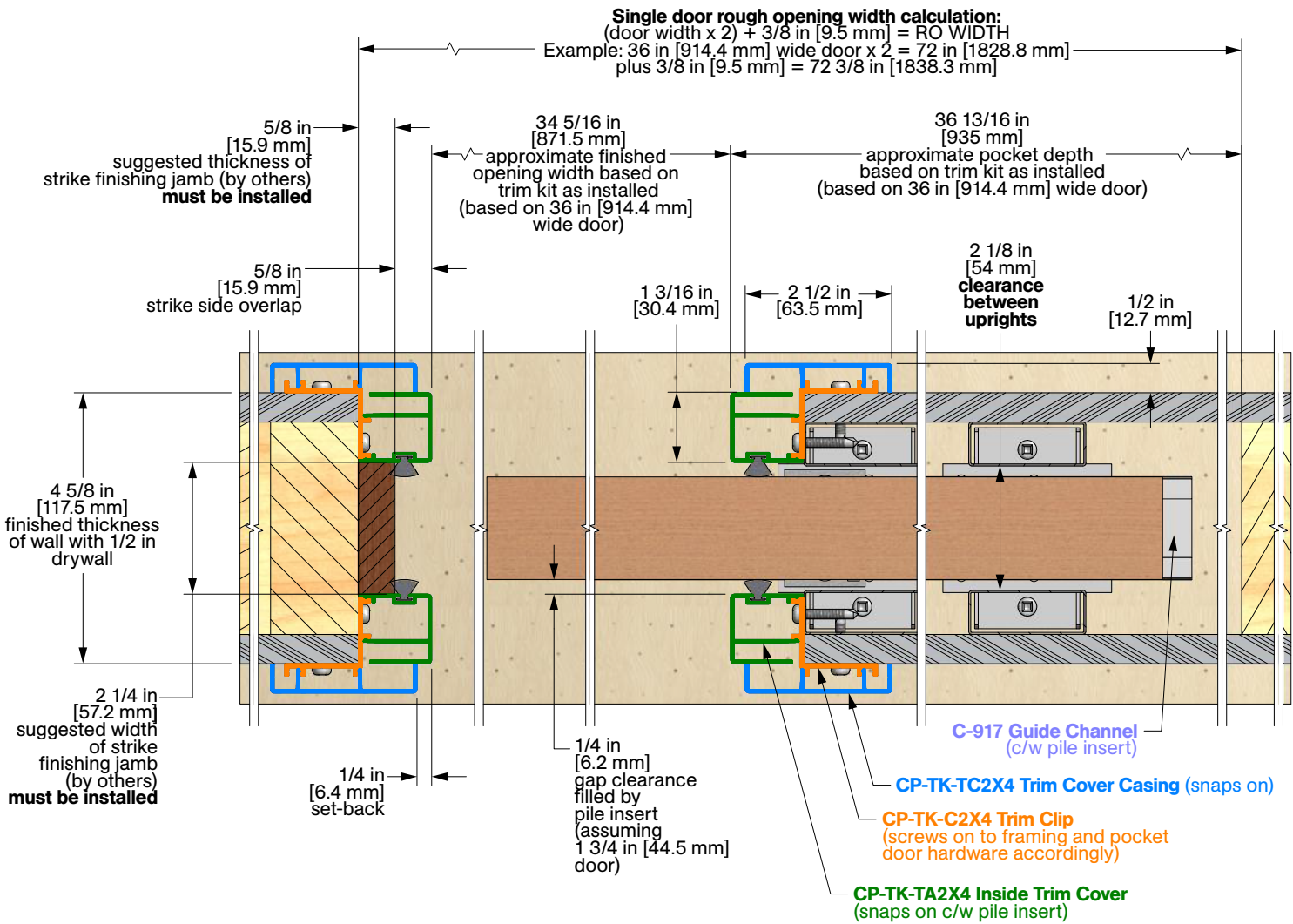

Open Position

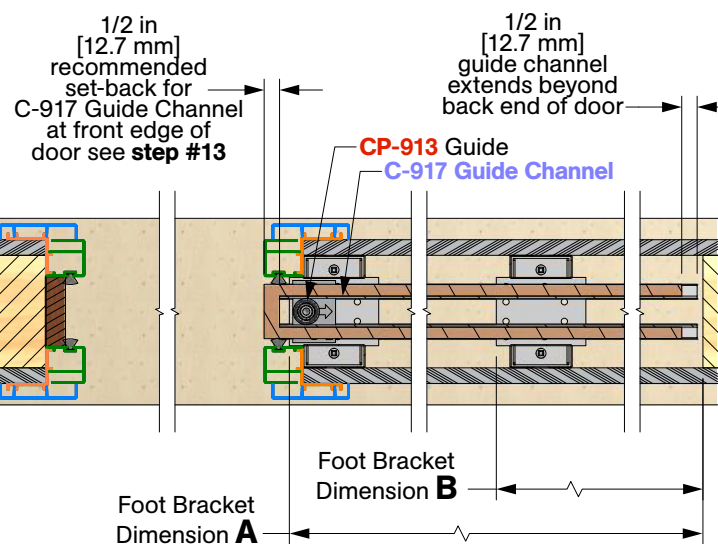

Closed Position

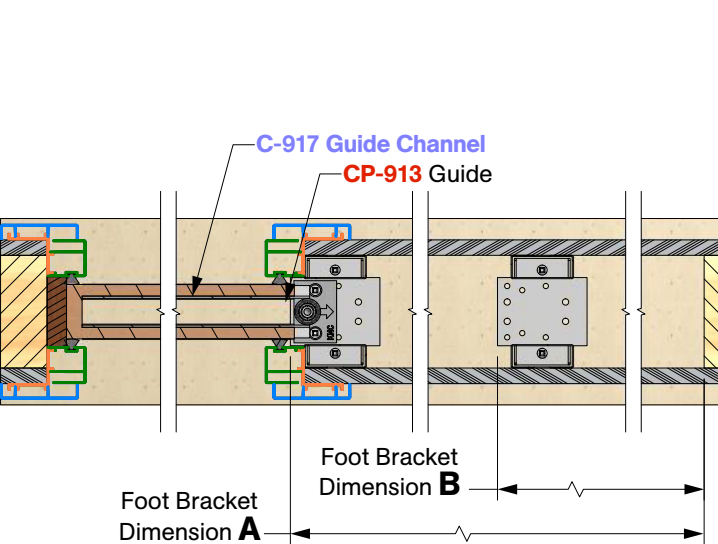

Parts List

(X) = quantity of item supplied in kits for doors up to 36 in [914 mm] wide x 84 in [2134 mm] or 2150mm high

-EXW4H8 (X) = quantity supplied in extra width and extra height kits for doors up to 48 in [1219 mm] wide x 96 in [2438 mm] or 2455mm high



CP-TK-C2X4 Clip x

(quantity and length options listed below)

For CP-TK-2X4 Kits for doors up to 36 in [914 mm] wide x 84 in [2134 mm] or 2150mm high:

(4) pieces x 84 in [2133.6 mm] c/w pre-punched holes

(2) pieces x 36 in [914.4 mm] c/w pre-punched holes

For CP-TK-2X4-EXW4H8 Kits for doors up to 48 in [1219 mm] wide x 96 in [2438 mm] or 2455mm high:

(4) pieces x 96 in [2438.4 mm] c/w pre-punched holes

(2) pieces x 48 in [1219.2 mm] c/w pre-punched holes

#8 x 1" Self-Drilling Screw (75)
-EXW4H8 (85)
[FT31]

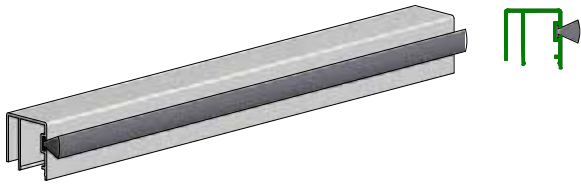

CP-TK-TA2X4 Inside Trim Cover x

(quantity and length options listed below)

For CP-TK-2X4 Kits for doors up to 36 in [914 mm] wide x 84 in [2134 mm] or 2150mm high:

(4) pieces x 86 in [2183.3 mm] c/w pile insert

(2) pieces x 38 in [965.2 mm] c/w pile insert

For CP-TK-2X4-EXW4H8 Kits for doors up to 48 in [1219 mm] wide x 96 in [2438 mm] or 2455mm high:

(4) pieces x 98 in [2489.2 mm] c/w pile insert

(2) pieces x 50 in [1270 mm] c/w pile insert

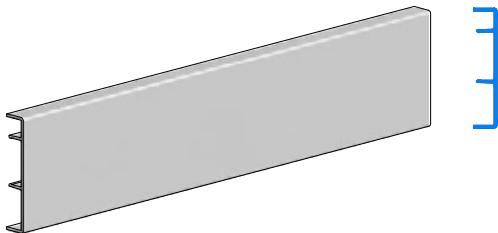

CP-TK-TC2X4 Trim Cover Casing x

(quantity and length options listed below)

For CP-TK-2X4 Kits for doors up to 36 in [914 mm] wide x 84 in [2134 mm] or 2150mm high:

(4) pieces x 88 in [2235.2 mm]

(2) pieces x 43 in [1092.2 mm]

For CP-TK-2X4-EXW4H8 Kits for doors up to 48 in [1219 mm] wide x 96 in [2438 mm] or 2455mm high:

(4) pieces x 100 in [2540 mm]

(2) pieces x 55 in [1397 mm]

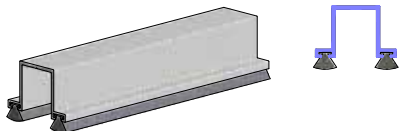

C-917 Guide Channel x

(quantity and length options listed below)

For CP-TK-2X4 Kits for doors up to 36 in [914 mm] wide x 84 in [2134 mm] or 2150mm high:

(1) piece x 36 in [914.4 mm] c/w pile insert

For CP-TK-2X4-EXW4H8 Kits for doors up to 48 in [1219 mm] wide x 96 in [2438 mm] or 2455mm high:

(1) piece x 48 in [1219.2 mm] c/w pile insert

Installation Steps

Steps #1 - 8:

Follow steps from Type CC-W single door pocket kit installation sheets, same for "NR" narrow kits.

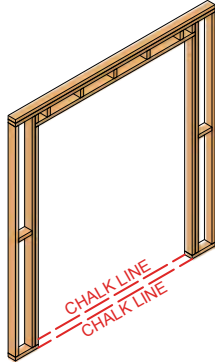

Step #TK-1:

Use a chalk line against bottom studs of wall to mark lines of opening on both sides as shown below. Locate and secure CP-2X4 Foot Brackets (2) or (3) for extra width kits with (2 per bracket) #8 x 3/4" Pan Head Screws [FT2] as per foot bracket location **Chart C** below.

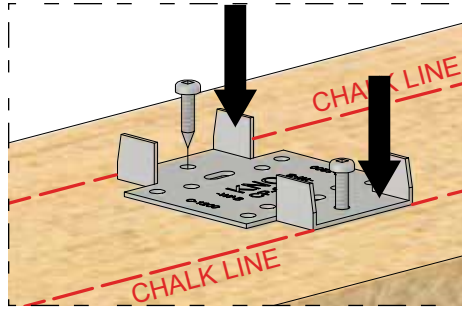

Note: Foot brackets are reversible. Foot brackets are to be mounted on finished floor. If finished floor is not installed, shim foot brackets to thickness of finished floor. Foot bracket location dimensions are based on standard set-up. Foot bracket location dimensions are based using the CP-TK-2X4 Pocket Trim Kit as per dimension details found on previous pages. For double/bi-parting doors kits, refer to **step #TKD-1** in CPD-TK-2X4 Trim Kit installation sheet before proceeding.

Chart C: Foot bracket location dimensions A, B, C

Door width			Dimension A		Dimension B		Dimension C
18 in	(1'-6")	[457 mm]	19 1/2 in	[495 mm]	10 1/2 in	[267 mm]	----
20 in	(1'-8")	[508 mm]	21 1/2 in	[546 mm]	10 1/2 in	[267 mm]	----
22 in	(1'-10")	[559 mm]	23 1/2 in	[597 mm]	11 1/2 in	[292 mm]	----
24 in	(2'-0")	[610 mm]	25 1/2 in	[648 mm]	11 1/2 in	[292 mm]	----
26 in	(2'-2")	[660 mm]	27 1/2 in	[699 mm]	12 1/2 in	[318 mm]	----
28 in	(2'-4")	[711 mm]	29 1/2 in	[749 mm]	13 1/2 in	[343 mm]	----
30 in	(2'-6")	[762 mm]	31 1/2 in	[800 mm]	15 1/2 in	[394 mm]	----
32 in	(2'-8")	[813 mm]	33 1/2 in	[851 mm]	15 1/2 in	[394 mm]	----
34 in	(2'-10")	[864 mm]	35 1/2 in	[902 mm]	17 1/2 in	[445 mm]	----
36 in	(3'-0")	[914 mm]	37 1/2 in	[953 mm]	19 1/2 in	[495 mm]	----
Below apply to -EXW4 (extra width) Crowder Frame pocket door kits							
38 in	(3'-2")	[965 mm]	39 1/2 in	[1003 mm]	26 1/2 in	[673 mm]	13 1/2 in [343 mm]
40 in	(3'-4")	[1016 mm]	41 1/2 in	[1054 mm]	28 1/2 in	[724 mm]	15 1/2 in [394 mm]
42 in	(3'-6")	[1067 mm]	43 1/2 in	[1105 mm]	29 1/2 in	[749 mm]	15 1/2 in [394 mm]
44 in	(3'-8")	[1118 mm]	45 1/2 in	[1156 mm]	31 1/2 in	[800 mm]	17 1/2 in [445 mm]
46 in	(3'-10")	[1169 mm]	47 1/2 in	[1207 mm]	32 1/2 in	[826 mm]	17 1/2 in [445 mm]
48 in	(4'-0")	[1219 mm]	49 1/2 in	[1257 mm]	33 1/2 in	[851 mm]	17 1/2 in [445 mm]

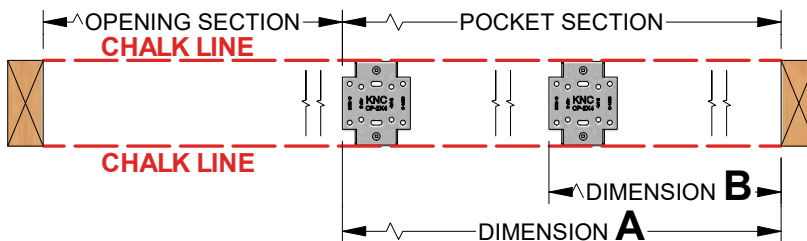

Standard Plan View
For doors 30 in [762 mm] to 36 in [914 mm] wide

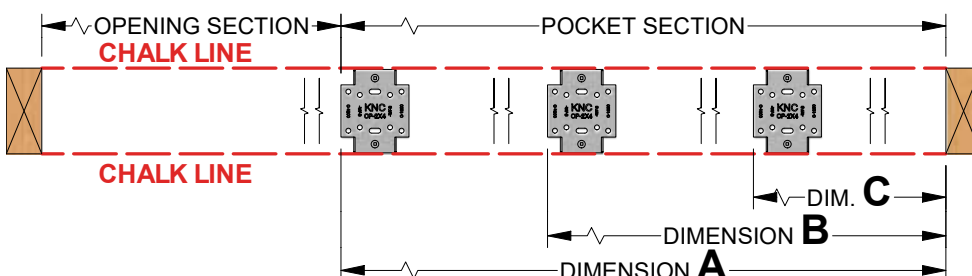

-EXW4 (extra width) Plan View
For doors 37 in [940 mm] to 48 in [1219 mm] wide

Step #TK-2:

Place CP-913 Guide (1) on foot bracket closest to opening end and secure with two (2) #10 x 1-3/4" Flat Head Screws.

Note: Ensure arrow ID on the CP-913 Guide is facing towards pocket as shown right.

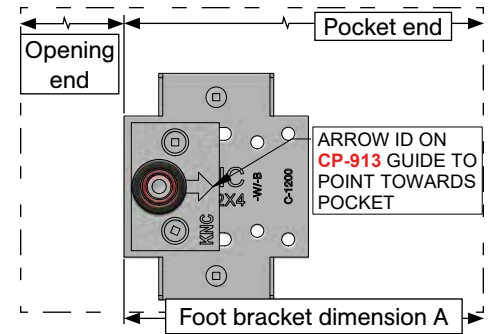
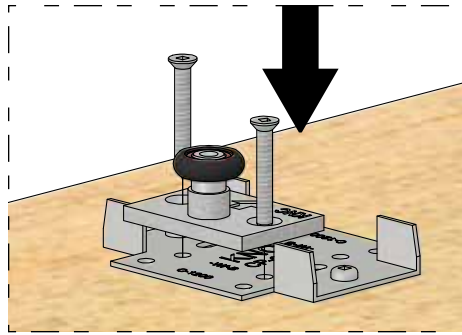
**Steps #11, 12, and 14:**

Follow steps from Type CC-W single door pocket kit installation sheet, same for "NR" narrow kits.

Step #TK-3:

Prepare C-917 Guide Channel slot in bottom of door:

1 in [25.4 mm] wide in center of door, 29/32 in [22.9 mm] deep and set back 1/2 in [12.7 mm] from front edge of door. It is recommended to make slot as accurate as possible for secure fit and neat appearance.

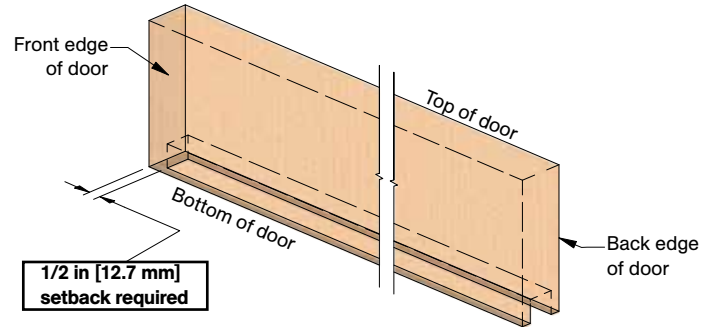
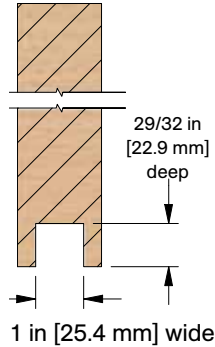
**Step #TK-4:**

Cut C-917 aluminum guide channel to correct length as required. Drill holes in C-917 Guide Channel and pre-drill holes in door. Locate C-917 Guide Channel in slot and screw channel into place with #8 x 3/4" Pan Head Screws [FT2], 4 screws are provided in Type CC-W Crowder Frame Pocket Door Kit.

Steps #16 - 32:

Follow steps from Type CC-W single door pocket kit installation sheet. For "NR" narrow kits, follow **steps #16 - 27**.

Note: For steps that involve locating final position of door, ensure trim kit details are taken into consideration as per dimension details on previous pages. If not, door may not open and close properly once the trim kit is installed.

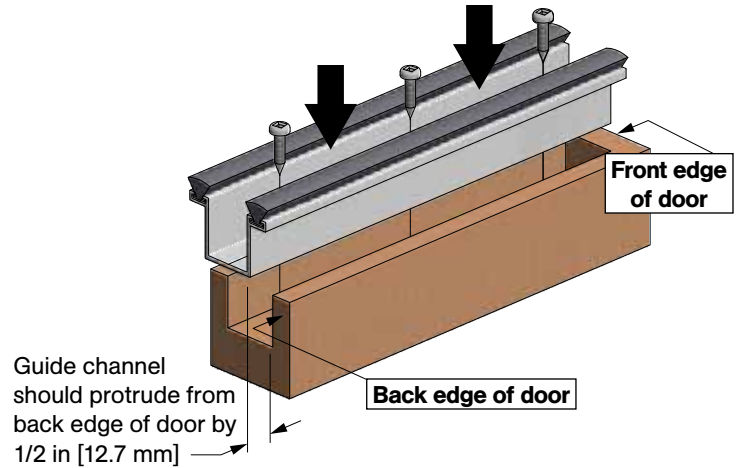
**Step #TK-5:**

Install drywall accordingly.

Note: Door can be removed from pocket before drywall is installed by disengaging the hanger from top plates on the door and removing door. This is installer/end user's preference as door can remain in pocket during this step.

Step #TK-6:

Measure opening from drywall to drywall and floor to top drywall as shown below. Cut CP-TK-C2X4 Clips to size if required. Two (2) equal horizontal lengths and four (4) equal vertical lengths are required.

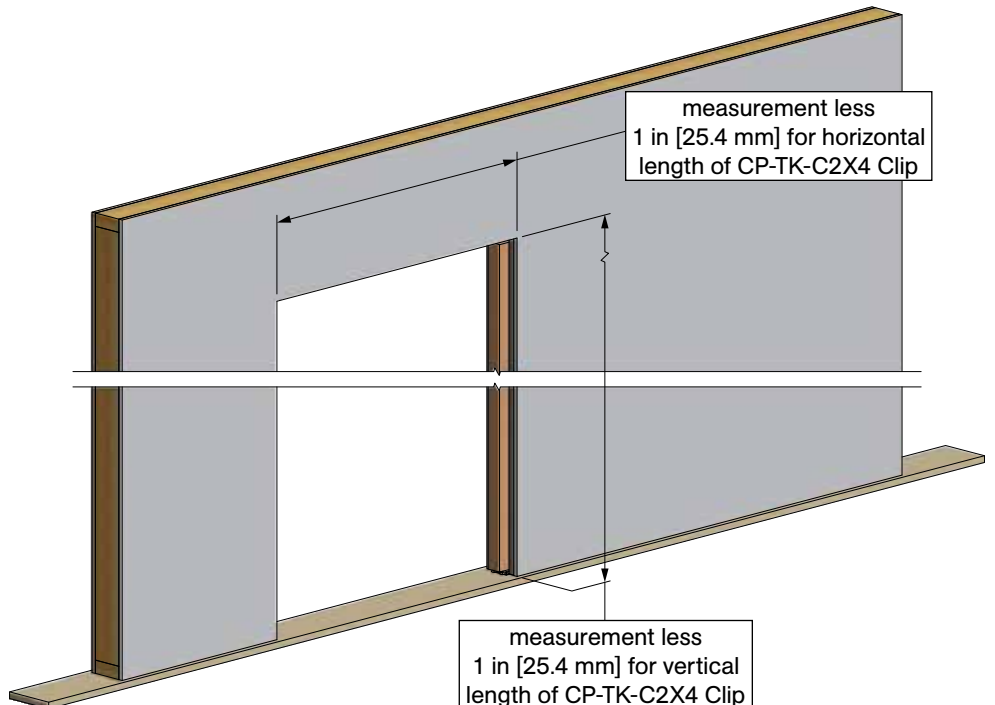

Step #TK-7:

Install six (6) pieces of CP-TK-C2X4 Clips cut to size in previous step with supplied #8 x 1" Self-Drilling Screws [FT31] as shown below.

Note: Orientation of clips are critical for covers to be installed correctly.

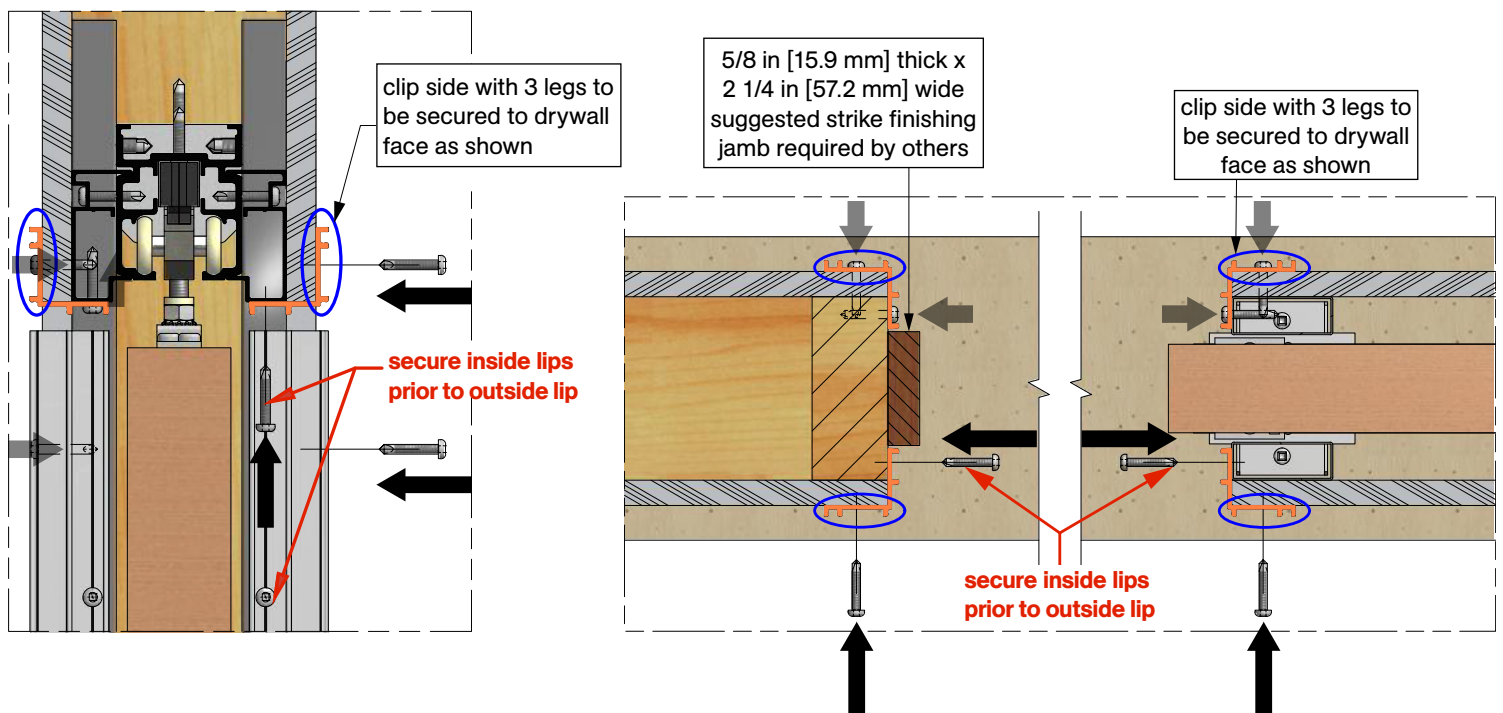
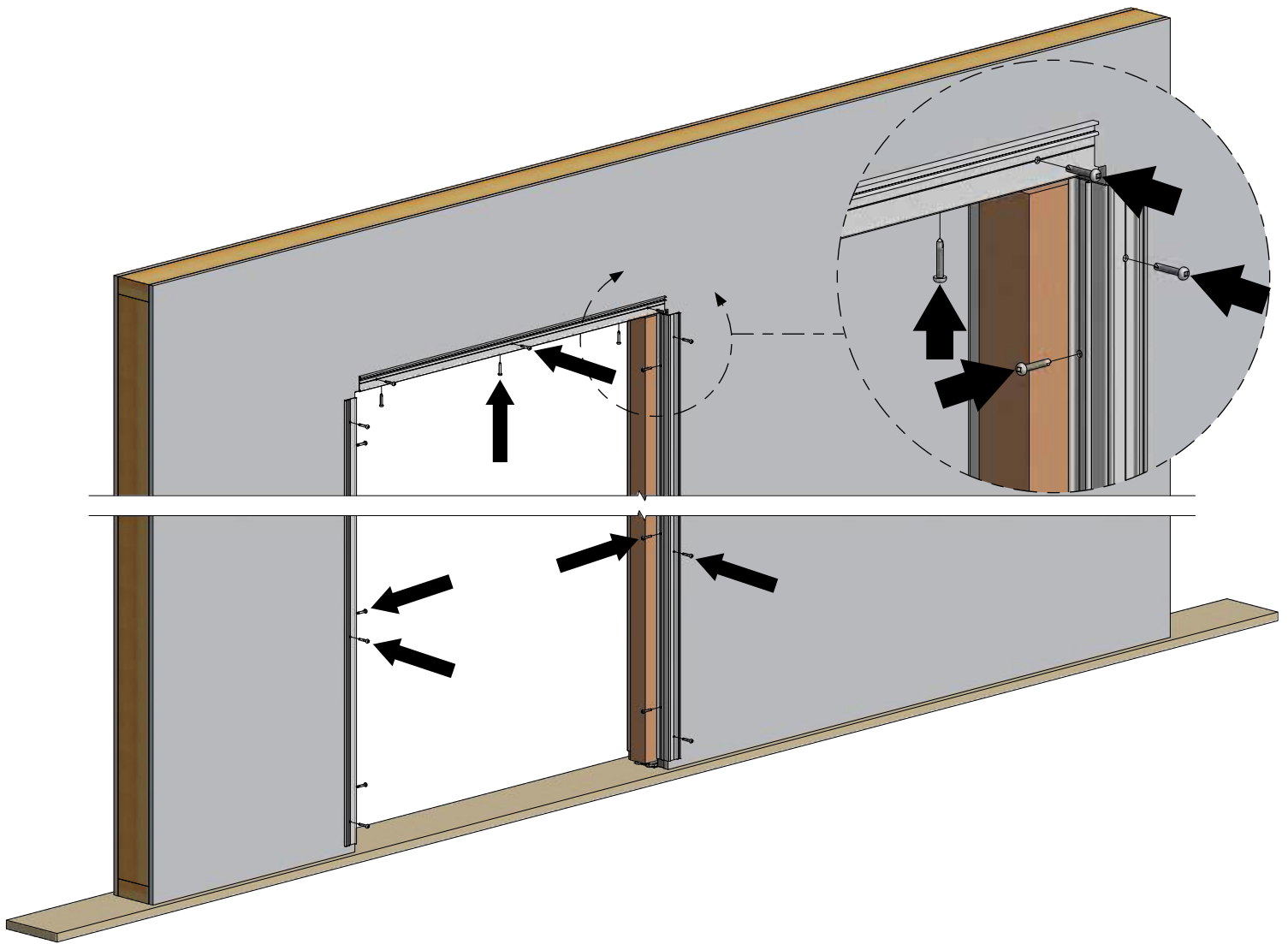

Step #TK-8:

Measure and cut two (2) horizontal lengths for the CP-TK-TA2X4 Inside Trim Covers as per details below. Snap covers into place onto horizontal clips previously installed.

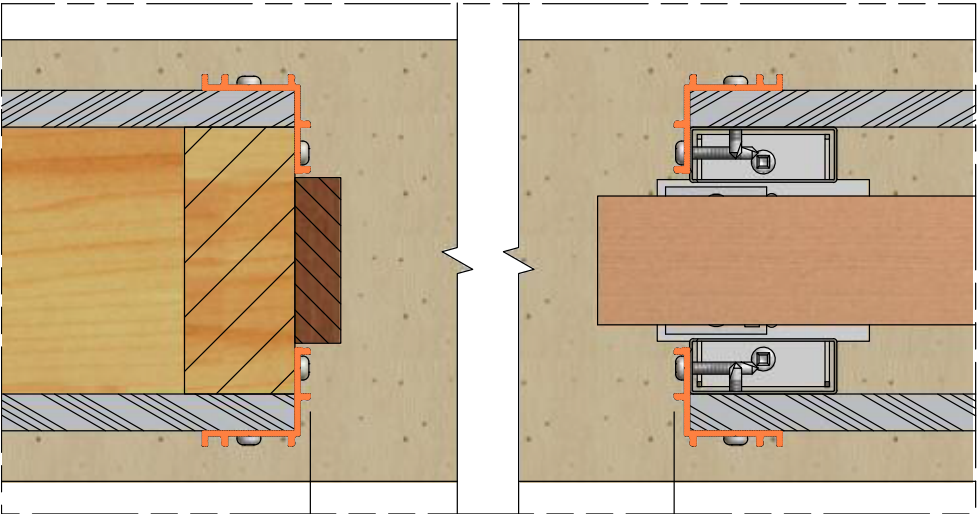

Measurement less 1/8 in [3.2 mm] between clips for horizontal length of CP-TK-TA2X4 Inside Cover

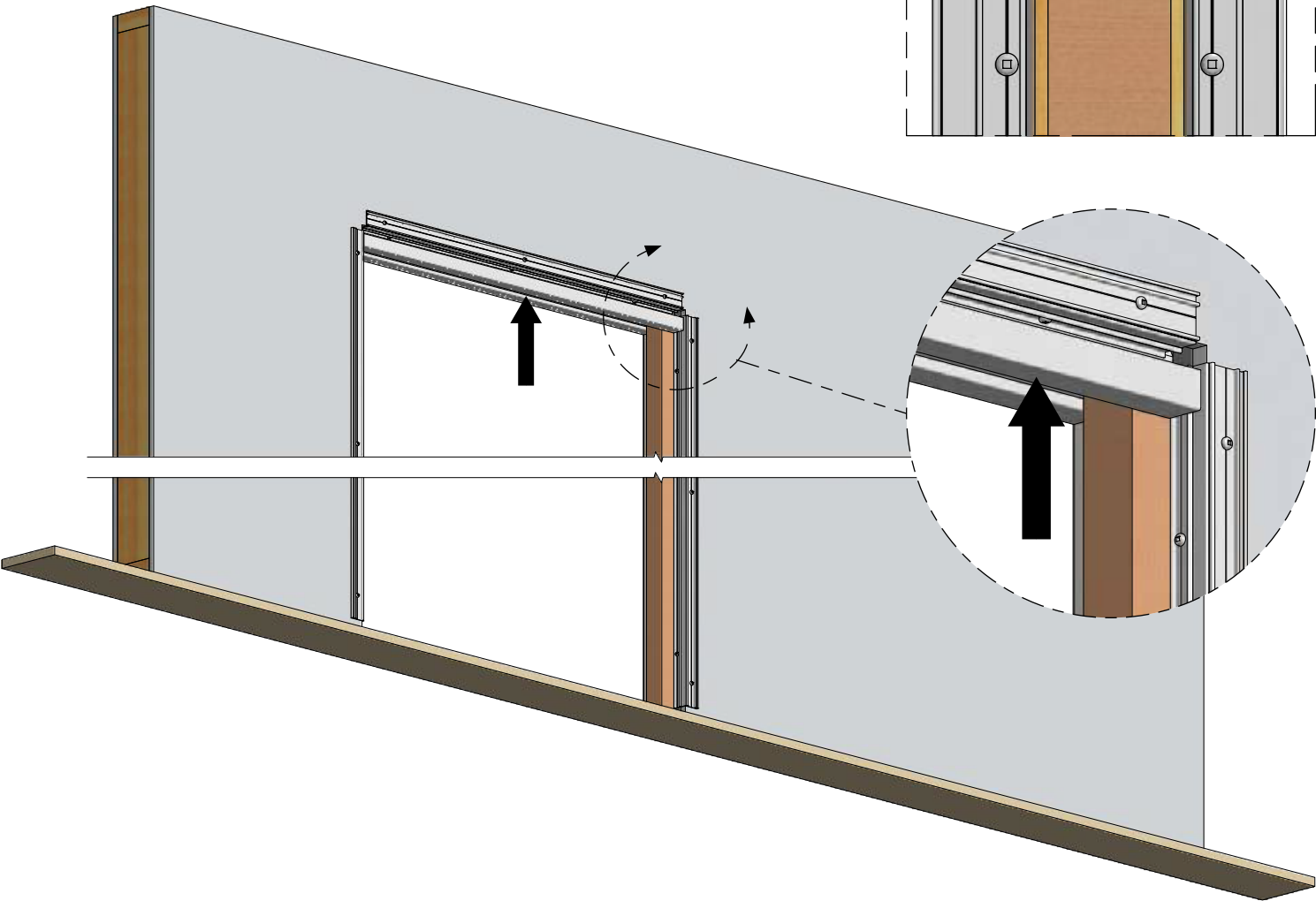
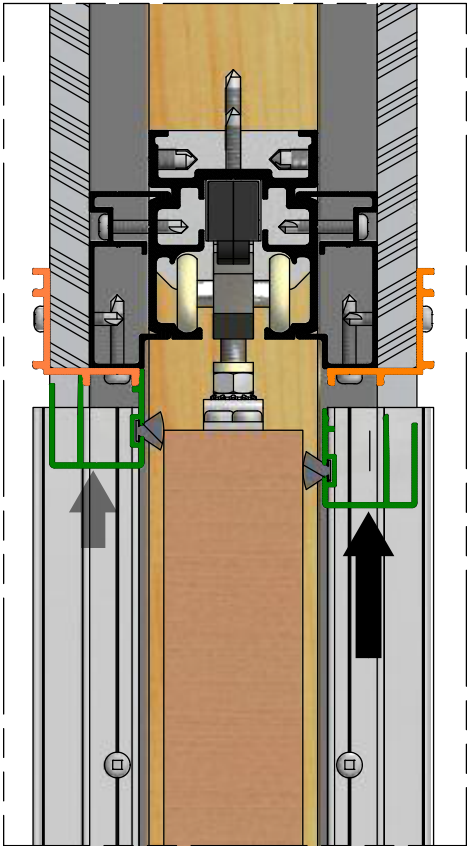

Step #TK-9:
Measure and cut four (4) vertical lengths of CP-TK-TA2X4 Inside Trim Covers as per details below. Snap covers into place onto vertical clips previously installed.

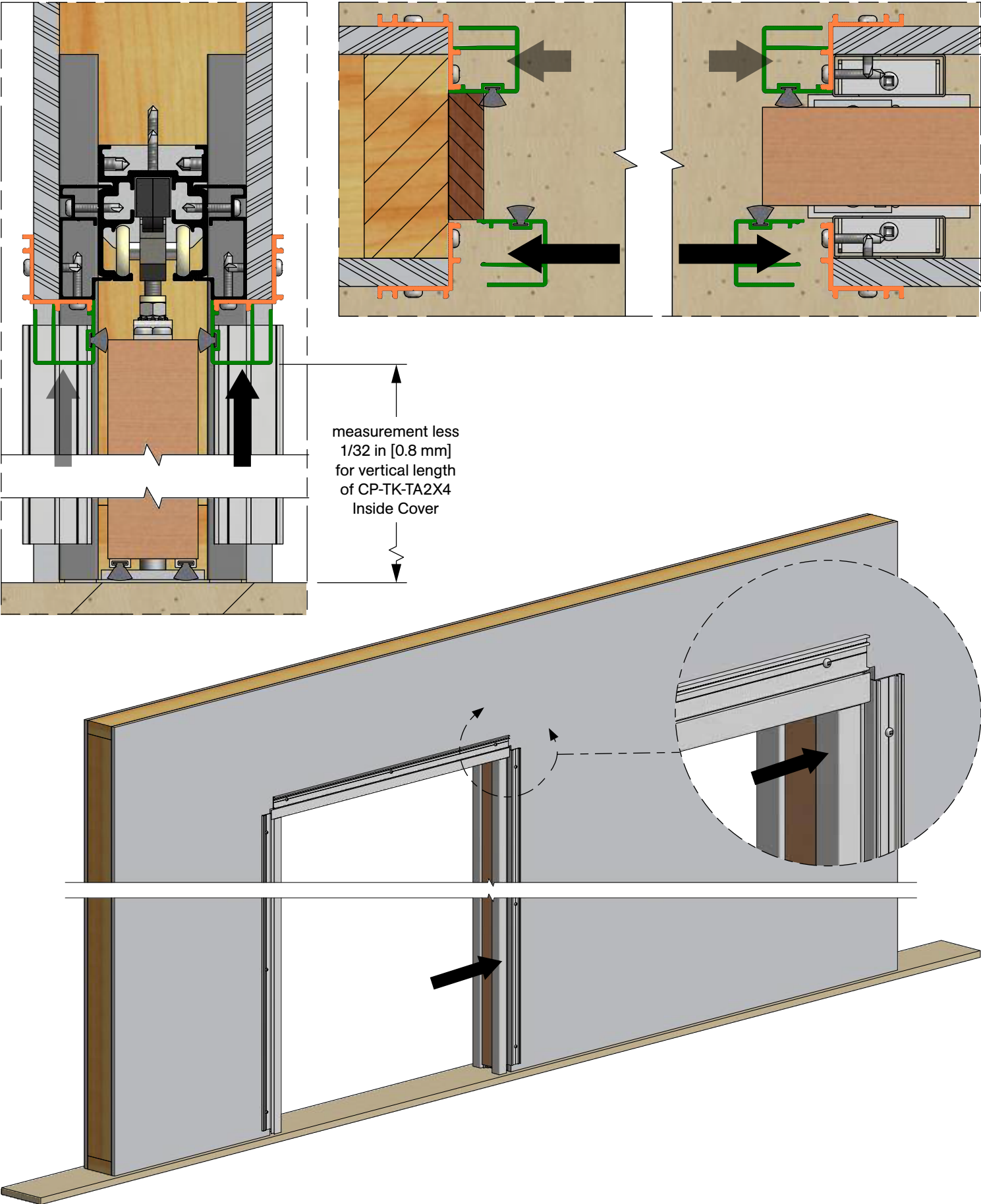

Step #TK-10:

Measure and cut two (2) horizontal lengths and four (4) vertical lengths of CP-TK-TC2X4 Trim Cover Casings as per details below. Snap covers into place onto clips previously installed. See below. For a neat appearance, it is recommended to mitre corners as shown below. However, clips can be installed with square ends as well. If using square edges, vertical lengths would be to top of horizontal trim cover casings and horizontal lengths would be installed in between vertical lengths.

