

# CRT-SP

## Single Round Bar Door Pull

Installation Instructions

Suitable for minimum 1 3/8 in [34.9 mm] thick doors  
Available in Ø1 in [25.4 mm] x 18 in [457.2 mm] or 36 in [914.4 mm] round bar door pull

### Center to Center Hole Spacing for Door Pull

Overall Pull Length	No. of Holes	Dimension CTC
18 in [457.2 mm]	2	14 in [355.6 mm]
36 in [914.4 mm]	2	28 in [711.2 mm]

### Product Dimension Details

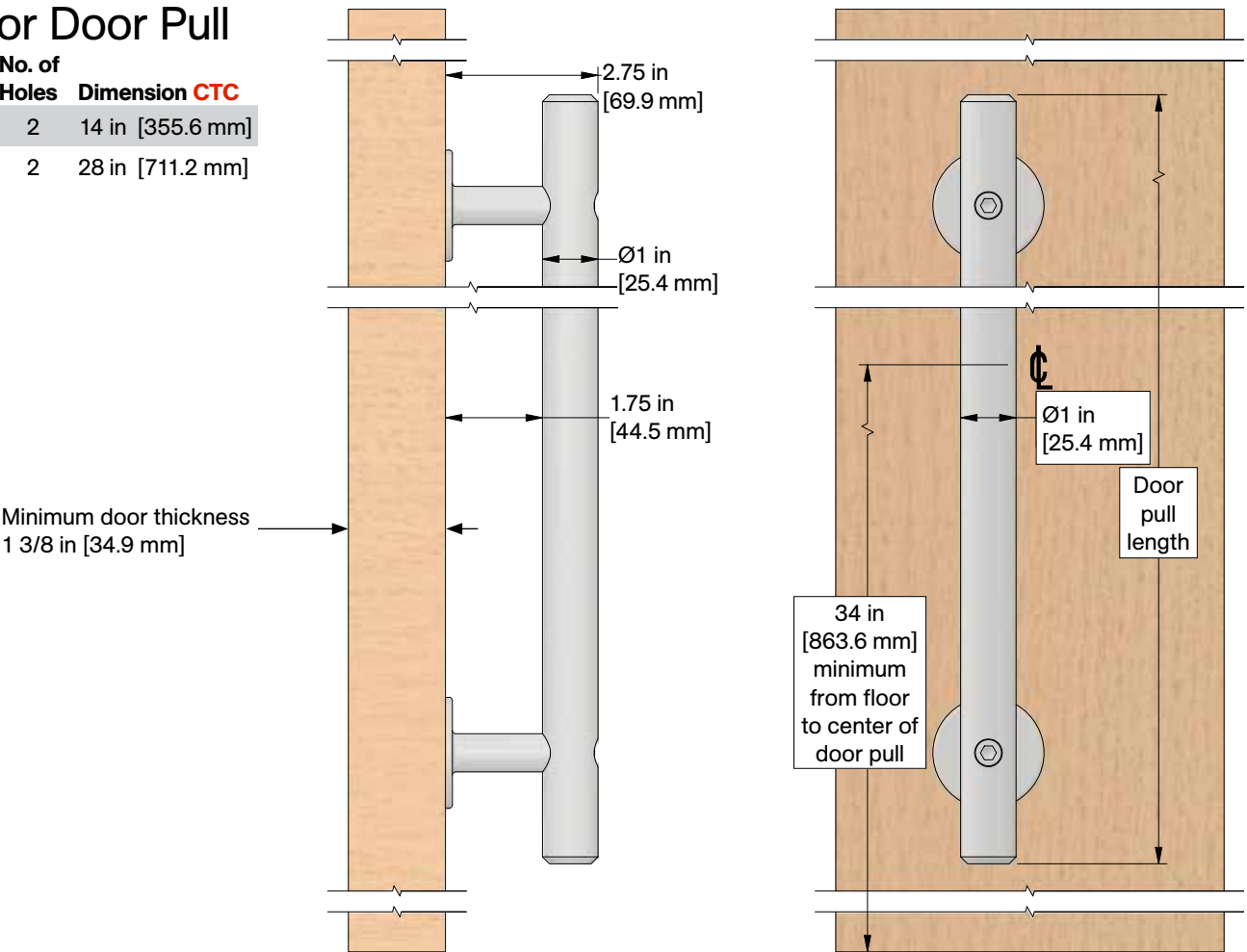

### Door Prep Details

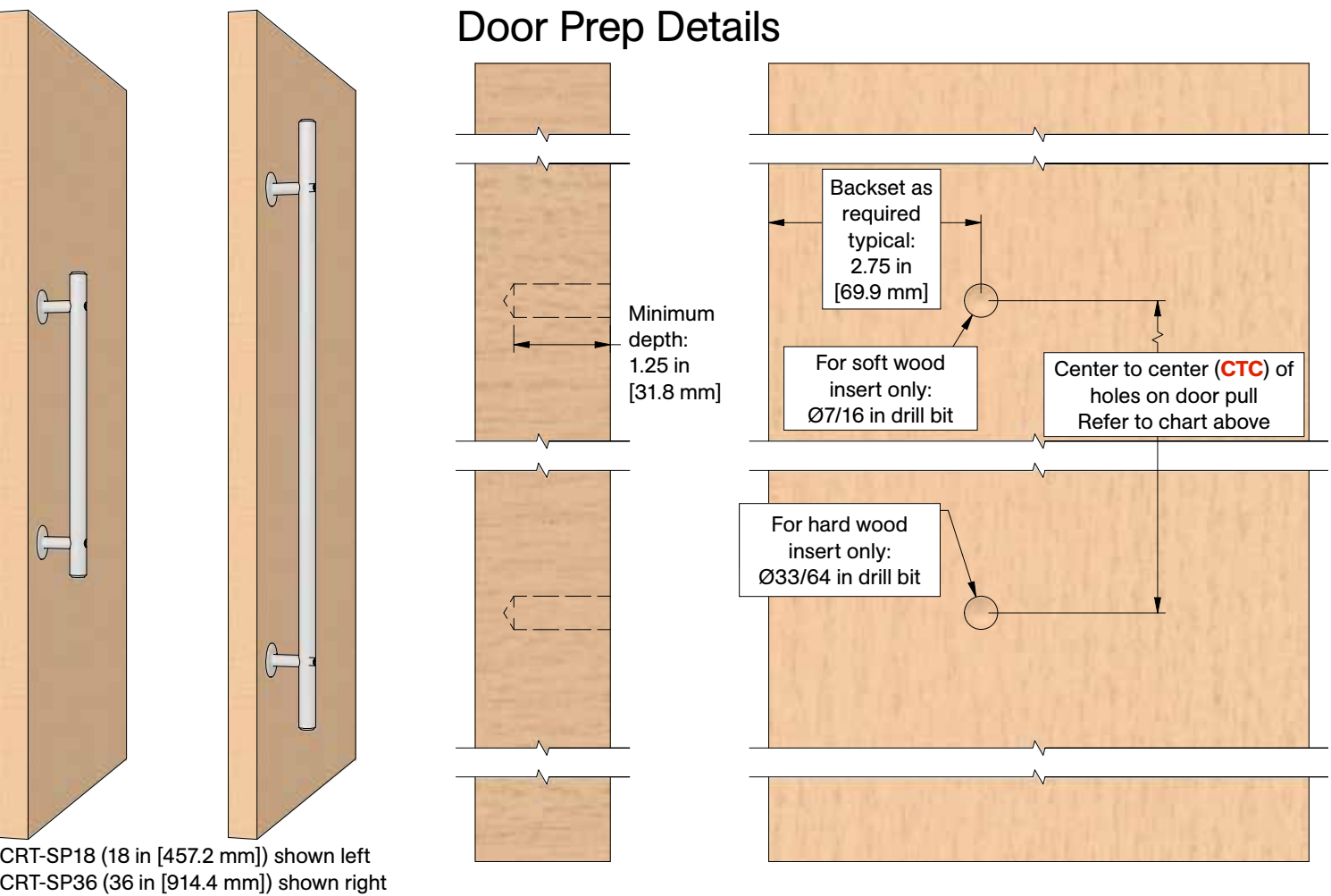

# Parts' List

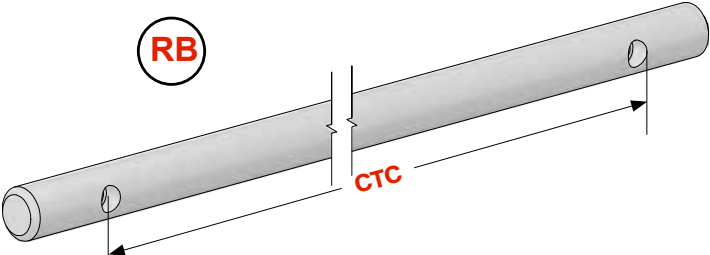

## Center to Center Hole Spacing for Door Pull

Overall Pull Length	No. of Holes	Dimension CTC
18 in [457.2 mm]	2	14 in [355.6 mm]
36 in [914.4 mm]	2	28 in [711.2 mm]

CRT-RBDP-[door pull length] Round Bar Door Pull (1)  
Door pull length, see chart right



5/16-18 Soft Wood Flange Anchor (2)



5/16-18 Hard Wood Knife Anchor (2)

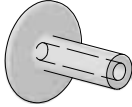

CRT-DPB-C (2)

Door pull bracket Type C, clearance hole through



5/16 18 x 3 1/2 inch Socket Head Cap Screw (2)

# Assembly

