

Crowder Slide

Rough Opening Guidelines

The dimensions provided in this document serve as general guidelines; actual sizes may vary. Please refer to the Approved Opening Layout drawing created by KN Crowder, using the information submitted on the Crowder Slide application form, for your specific dimensions.

If you are using these guidelines to construct your walls and rough opening, please verify the actual rough opening dimensions before approving the Opening Layout provided. It is the customer's responsibility to ensure that the openings are structurally sound and correctly sized to fit the custom Crowder Slide system.

Wall Details:

All testing for this product has been conducted with 3 5/8 in [92 mm] or 6 in [152.4 mm] metal stud framing, integrated with lumber framing for the rough opening to ensure adequate structural support for the Crowder Slide system. Framing requirements may vary by region; please refer to local building codes for specific details.

To guarantee proper support when using metal studs, verification by a certified structural engineer is required. Please note that KN Crowder is not responsible for framing details, and our warranty does not cover issues arising from improper structural support or framing.

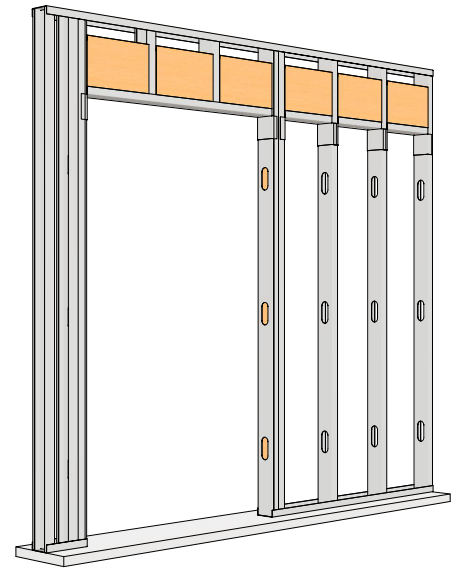

Note: Details are shown as **Right-hand Outside [RHO]** opening format

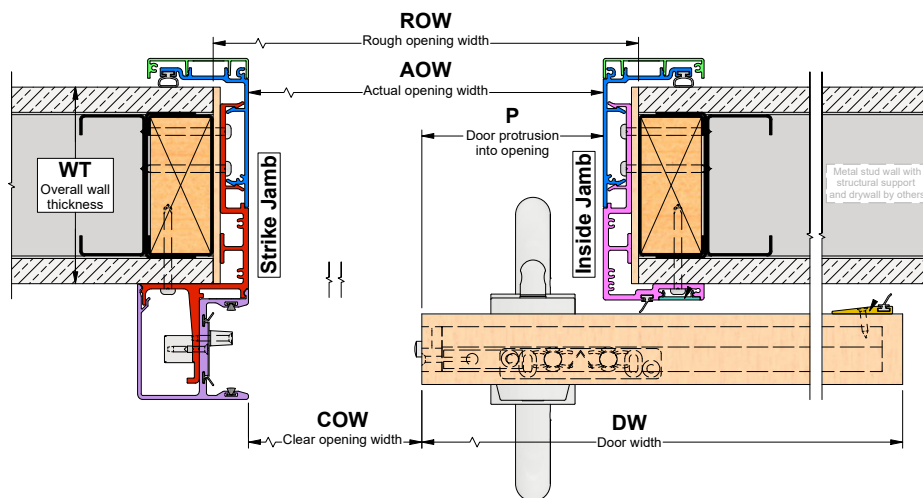

Shown as Crowder Slide-AR with CS-99 Sloped Fascia

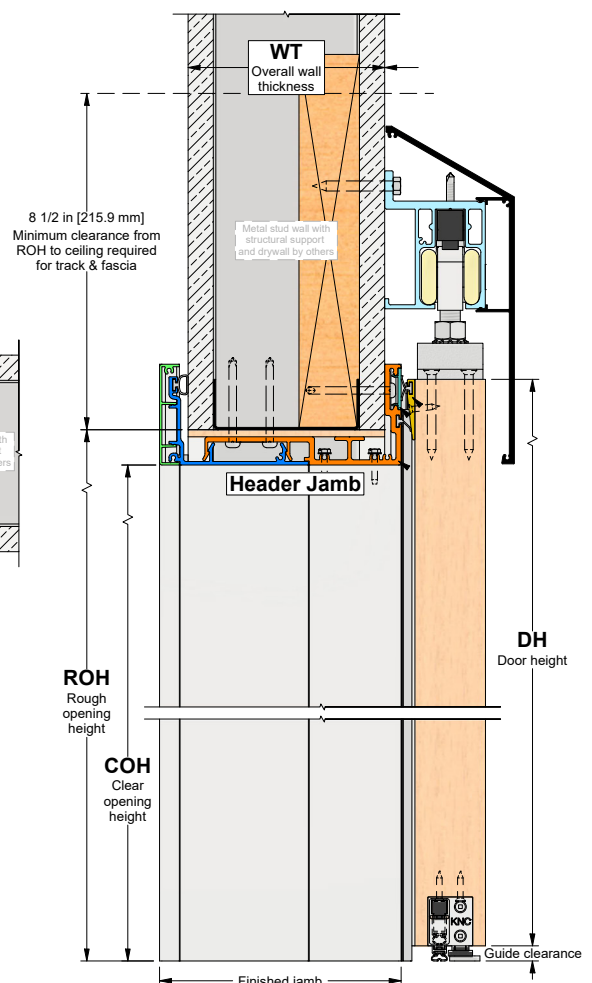

Note: Details are shown as **Right-hand Outside [RHO]** opening format

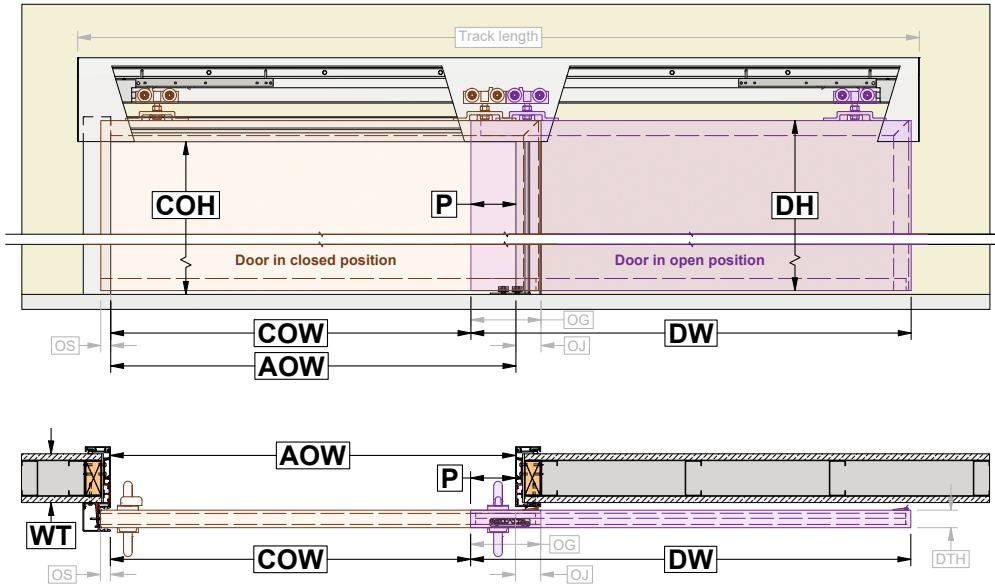

Maximum door size is 72 in [1829 mm] wide **[DW]** x 120 in [3048 mm] high **[DH]** x 1 3/4 in [45 mm] thick **[TH]**, weighing up to 300 lbs [136 kg].

Wall Thickness [WT]:

- **4 7/8 in [124 mm]** = 3 5/8 in [92.1 mm] stud with 5/8 in [15.9 mm] drywall per side
- **7 1/4 in [184 mm]** = 6 in [152.4 mm] stud with 5/8 in [15.9 mm] drywall per side
- Other thicknesses may be available upon request

Suggested minimum Opening Layout:

Door spec:

- **Door width [DW]** = 44 in [1118 mm]
- **Door height [DH]** = 84 in [2134 mm]
- **Door thickness [DTH]** = 1 3/4 in [45 mm]

Door protrusion [P] = 4 1/2 in [114.3 mm]

Clear opening width [COW] = 36 in [914 mm]

Clear opening height [COH] = 82 1/4 in [2089 mm]

Actual opening width [AOW] = 40 1/2 in [1029 mm]

Door overlap at strike side of opening [OS], fixed dimension = 1 in [25.4 mm]

Door overlap at jamb side of opening [OJ], minimum (default) = 2 1/2 in [63.5 mm]

Door overlap on guide system [OG], minimum 6 in [152.4 mm] required. Typically, door protrusion [P] + door overlap at jamb side [OJ]

Track length = Refer to the Approved Opening Layout drawing for the supplied length

Width Calculations:

Based on a precise 4 1/2 in [114.3 mm] door protrusion [P] and the clear opening width [COW], measured from the front edge of the door in the open position to the strike jamb cover.

Note: Varying door protrusions [P] or overlap at jamb side [OJ] will affect calculations below. Review with KN Crowder and obtain an

Opening Layout drawing for accurate dimensions.

- Rough opening width [ROW] = clear opening width [COW] + 6 1/4 in [158.8 mm]
- Door width [DW] = clear opening width [COW] + 8 in [203.2 mm]
- Structural support for track: It is recommended to extend at least 4 in [101.6 mm] beyond both the clear opening width [COW] and the door width [DW] in the open position, as shown below.

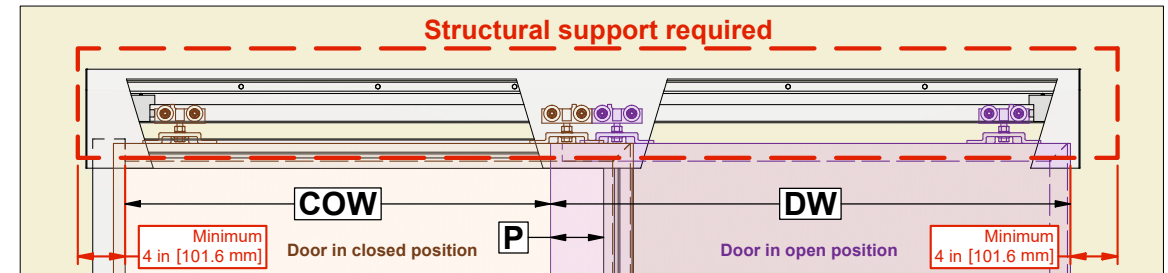

Height Calculations:

Clear opening height [COH] measured from floor to underside of header jamb cover.

- Rough opening height [ROH] = clear opening height [COH] + 7/8 in [22.2 mm]
- Door height [DH] = clear opening height [COH] + 1 3/4 in [44.5 mm]
- Clearance required to ceiling = clear opening height [COH] + 9 3/8 in [238.1 mm]

Crowder Slide Width

The dimensions in the following charts are based on selecting either the door size or clear opening while using a precise 4 1/2 in [114.3 mm] door protrusion [P].

Door Width [DW]		Clear Opening Width [COW]		Rough Opening Width [ROW]	
40 in	[1016 mm]	32 in	[812.8 mm]	38.25 in	[971.6 mm]
40.5 in	[1028.7 mm]	32.5 in	[825.5 mm]	38.75 in	[984.3 mm]
41 in	[1041.4 mm]	33 in	[838.2 mm]	39.25 in	[997 mm]
41.5 in	[1054.1 mm]	33.5 in	[850.9 mm]	39.75 in	[1009.7 mm]
42 in	[1066.8 mm]	34 in	[863.6 mm]	40.25 in	[1022.4 mm]
42.5 in	[1079.5 mm]	34.5 in	[876.3 mm]	40.75 in	[1035.1 mm]
43 in	[1092.2 mm]	35 in	[889 mm]	41.25 in	[1047.8 mm]
43.5 in	[1104.9 mm]	35.5 in	[901.7 mm]	41.75 in	[1060.5 mm]
44 in	[1117.6 mm]	36 in	[914.4 mm]	42.25 in	[1073.2 mm]
44.5 in	[1130.3 mm]	36.5 in	[927.1 mm]	42.75 in	[1085.9 mm]
45 in	[1143 mm]	37 in	[939.8 mm]	43.25 in	[1098.6 mm]
45.5 in	[1155.7 mm]	37.5 in	[952.5 mm]	43.75 in	[1111.3 mm]
46 in	[1168.4 mm]	38 in	[965.2 mm]	44.25 in	[1124 mm]
46.5 in	[1181.1 mm]	38.5 in	[977.9 mm]	44.75 in	[1136.7 mm]
47 in	[1193.8 mm]	39 in	[990.6 mm]	45.25 in	[1149.4 mm]
47.5 in	[1206.5 mm]	39.5 in	[1003.3 mm]	45.75 in	[1162.1 mm]
48 in	[1219.2 mm]	40 in	[1016 mm]	46.25 in	[1174.8 mm]
48.5 in	[1231.9 mm]	40.5 in	[1028.7 mm]	46.75 in	[1187.5 mm]
49 in	[1244.6 mm]	41 in	[1041.4 mm]	47.25 in	[1200.2 mm]
49.5 in	[1257.3 mm]	41.5 in	[1054.1 mm]	47.75 in	[1212.9 mm]
50 in	[1270 mm]	42 in	[1066.8 mm]	48.25 in	[1225.6 mm]
50.5 in	[1282.7 mm]	42.5 in	[1079.5 mm]	48.75 in	[1238.3 mm]
51 in	[1295.4 mm]	43 in	[1092.2 mm]	49.25 in	[1251 mm]
51.5 in	[1308.1 mm]	43.5 in	[1104.9 mm]	49.75 in	[1263.7 mm]
52 in	[1320.8 mm]	44 in	[1117.6 mm]	50.25 in	[1276.4 mm]
52.5 in	[1333.5 mm]	44.5 in	[1130.3 mm]	50.75 in	[1289.1 mm]
53 in	[1346.2 mm]	45 in	[1143 mm]	51.25 in	[1301.8 mm]
53.5 in	[1358.9 mm]	45.5 in	[1155.7 mm]	51.75 in	[1314.5 mm]
54 in	[1371.6 mm]	46 in	[1168.4 mm]	52.25 in	[1327.2 mm]

Door Width [DW]		Clear Opening Width [COW]		Rough Opening Width [ROW]	
54.5 in	[1384.3 mm]	46.5 in	[1181.1 mm]	52.75 in	[1339.9 mm]
55 in	[1397 mm]	47 in	[1193.8 mm]	53.25 in	[1352.6 mm]
55.5 in	[1409.7 mm]	47.5 in	[1206.5 mm]	53.75 in	[1365.3 mm]
56 in	[1422.4 mm]	48 in	[1219.2 mm]	54.25 in	[1378 mm]
56.5 in	[1435.1 mm]	48.5 in	[1231.9 mm]	54.75 in	[1390.7 mm]
57 in	[1447.8 mm]	49 in	[1244.6 mm]	55.25 in	[1403.4 mm]
57.5 in	[1460.5 mm]	49.5 in	[1257.3 mm]	55.75 in	[1416.1 mm]
58 in	[1473.2 mm]	50 in	[1270 mm]	56.25 in	[1428.8 mm]
58.5 in	[1485.9 mm]	50.5 in	[1282.7 mm]	56.75 in	[1441.5 mm]
59 in	[1498.6 mm]	51 in	[1295.4 mm]	57.25 in	[1454.2 mm]
59.5 in	[1511.3 mm]	51.5 in	[1308.1 mm]	57.75 in	[1466.9 mm]
60 in	[1524 mm]	52 in	[1320.8 mm]	58.25 in	[1479.6 mm]
60.5 in	[1536.7 mm]	52.5 in	[1333.5 mm]	58.75 in	[1492.3 mm]
61 in	[1549.4 mm]	53 in	[1346.2 mm]	59.25 in	[1505 mm]
61.5 in	[1562.1 mm]	53.5 in	[1358.9 mm]	59.75 in	[1517.7 mm]
62 in	[1574.8 mm]	54 in	[1371.6 mm]	60.25 in	[1530.4 mm]
62.5 in	[1587.5 mm]	54.5 in	[1384.3 mm]	60.75 in	[1543.1 mm]
63 in	[1600.2 mm]	55 in	[1397 mm]	61.25 in	[1555.8 mm]
63.5 in	[1612.9 mm]	55.5 in	[1409.7 mm]	61.75 in	[1568.5 mm]
64 in	[1625.6 mm]	56 in	[1422.4 mm]	62.25 in	[1581.2 mm]
64.5 in	[1638.3 mm]	56.5 in	[1435.1 mm]	62.75 in	[1593.9 mm]
65 in	[1651 mm]	57 in	[1447.8 mm]	63.25 in	[1606.6 mm]
65.5 in	[1663.7 mm]	57.5 in	[1460.5 mm]	63.75 in	[1619.3 mm]
66 in	[1676.4 mm]	58 in	[1473.2 mm]	64.25 in	[1632 mm]
66.5 in	[1689.1 mm]	58.5 in	[1485.9 mm]	64.75 in	[1644.7 mm]
67 in	[1701.8 mm]	59 in	[1498.6 mm]	65.25 in	[1657.4 mm]
67.5 in	[1714.5 mm]	59.5 in	[1511.3 mm]	65.75 in	[1670.1 mm]
68 in	[1727.2 mm]	60 in	[1524 mm]	66.25 in	[1682.8 mm]

Crowder Slide Height

Door Height [DH]		Clear Opening Height [COH]		Rough Opening Height [ROH]		Door Height [DH]		Clear Opening Height [COH]		Rough Opening Height [ROH]	
80 in	[2032 mm]	78.25 in	[1987.6 mm]	79.125 in	[2009.8 mm]	94 in	[2387.6 mm]	92.25 in	[2343.2 mm]	93.125 in	[2365.4 mm]
80.5 in	[2044.7 mm]	78.75 in	[2000.3 mm]	79.625 in	[2022.5 mm]	94.5 in	[2400.3 mm]	92.75 in	[2355.9 mm]	93.625 in	[2378.1 mm]
81 in	[2057.4 mm]	79.25 in	[2013 mm]	80.125 in	[2035.2 mm]	95 in	[2413 mm]	93.25 in	[2368.6 mm]	94.125 in	[2390.8 mm]
81.5 in	[2070.1 mm]	79.75 in	[2025.7 mm]	80.625 in	[2047.9 mm]	95.5 in	[2425.7 mm]	93.75 in	[2381.3 mm]	94.625 in	[2403.5 mm]
82 in	[2082.8 mm]	80.25 in	[2038.4 mm]	81.125 in	[2060.6 mm]	96 in	[2438.4 mm]	94.25 in	[2394 mm]	95.125 in	[2416.2 mm]
82.5 in	[2095.5 mm]	80.75 in	[2051.1 mm]	81.625 in	[2073.3 mm]	96.5 in	[2451.1 mm]	94.75 in	[2406.7 mm]	95.625 in	[2428.9 mm]
83 in	[2108.2 mm]	81.25 in	[2063.8 mm]	82.125 in	[2086 mm]	97 in	[2463.8 mm]	95.25 in	[2419.4 mm]	96.125 in	[2441.6 mm]
83.5 in	[2120.9 mm]	81.75 in	[2076.5 mm]	82.625 in	[2098.7 mm]	97.5 in	[2476.5 mm]	95.75 in	[2432.1 mm]	96.625 in	[2454.3 mm]
84 in	[2133.6 mm]	82.25 in	[2089.2 mm]	83.125 in	[2111.4 mm]	98 in	[2489.2 mm]	96.25 in	[2444.8 mm]	97.125 in	[2467 mm]
84.5 in	[2146.3 mm]	82.75 in	[2101.9 mm]	83.625 in	[2124.1 mm]	98.5 in	[2501.9 mm]	96.75 in	[2457.5 mm]	97.625 in	[2479.7 mm]
84.646 in	[2150 mm]	82.896 in	[2105.6 mm]	83.771 in	[2127.8 mm]	99 in	[2514.6 mm]	97.25 in	[2470.2 mm]	98.125 in	[2492.4 mm]
85 in	[2159 mm]	83.25 in	[2114.6 mm]	84.125 in	[2136.8 mm]	99.5 in	[2527.3 mm]	97.75 in	[2482.9 mm]	98.625 in	[2505.1 mm]
85.5 in	[2171.7 mm]	83.75 in	[2127.3 mm]	84.625 in	[2149.5 mm]	100 in	[2540 mm]	98.25 in	[2495.6 mm]	99.125 in	[2517.8 mm]
86 in	[2184.4 mm]	84.25 in	[2140 mm]	85.125 in	[2162.2 mm]	100.5 in	[2552.7 mm]	98.75 in	[2508.3 mm]	99.625 in	[2530.5 mm]
86.5 in	[2197.1 mm]	84.75 in	[2152.7 mm]	85.625 in	[2174.9 mm]	101 in	[2565.4 mm]	99.25 in	[2521 mm]	100.125 in	[2543.2 mm]
87 in	[2209.8 mm]	85.25 in	[2165.4 mm]	86.125 in	[2187.6 mm]	101.5 in	[2578.1 mm]	99.75 in	[2533.7 mm]	100.625 in	[2555.9 mm]
87.5 in	[2222.5 mm]	85.75 in	[2178.1 mm]	86.625 in	[2200.3 mm]	102 in	[2590.8 mm]	100.25 in	[2546.4 mm]	101.125 in	[2568.6 mm]
88 in	[2235.2 mm]	86.25 in	[2190.8 mm]	87.125 in	[2213 mm]	102.5 in	[2603.5 mm]	100.75 in	[2559.1 mm]	101.625 in	[2581.3 mm]
88.5 in	[2247.9 mm]	86.75 in	[2203.5 mm]	87.625 in	[2225.7 mm]	103 in	[2616.2 mm]	101.25 in	[2571.8 mm]	102.125 in	[2594 mm]
89 in	[2260.6 mm]	87.25 in	[2216.2 mm]	88.125 in	[2238.4 mm]	103.5 in	[2628.9 mm]	101.75 in	[2584.5 mm]	102.625 in	[2606.7 mm]
89.5 in	[2273.3 mm]	87.75 in	[2228.9 mm]	88.625 in	[2251.1 mm]	104 in	[2641.6 mm]	102.25 in	[2597.2 mm]	103.125 in	[2619.4 mm]
90 in	[2286 mm]	88.25 in	[2241.6 mm]	89.125 in	[2263.8 mm]	104.5 in	[2654.3 mm]	102.75 in	[2609.9 mm]	103.625 in	[2632.1 mm]
90.5 in	[2298.7 mm]	88.75 in	[2254.3 mm]	89.625 in	[2276.5 mm]	105 in	[2667 mm]	103.25 in	[2622.6 mm]	104.125 in	[2644.8 mm]
91 in	[2311.4 mm]	89.25 in	[2267 mm]	90.125 in	[2289.2 mm]	105.5 in	[2679.7 mm]	103.75 in	[2635.3 mm]	104.625 in	[2657.5 mm]
91.5 in	[2324.1 mm]	89.75 in	[2279.7 mm]	90.625 in	[2301.9 mm]	106 in	[2692.4 mm]	104.25 in	[2648 mm]	105.125 in	[2670.2 mm]
92 in	[2336.8 mm]	90.25 in	[2292.4 mm]	91.125 in	[2314.6 mm]	106.5 in	[2705.1 mm]	104.75 in	[2660.7 mm]	105.625 in	[2682.9 mm]
92.5 in	[2349.5 mm]	90.75 in	[2305.1 mm]	91.625 in	[2327.3 mm]	107 in	[2717.8 mm]	105.25 in	[2673.4 mm]	106.125 in	[2695.6 mm]
93 in	[2362.2 mm]	91.25 in	[2317.8 mm]	92.125 in	[2340 mm]	107.5 in	[2730.5 mm]	105.75 in	[2686.1 mm]	106.625 in	[2708.3 mm]
93.5 in	[2374.9 mm]	91.75 in	[2330.5 mm]	92.625 in	[2352.7 mm]	108 in	[2743.2 mm]	106.25 in	[2698.8 mm]	107.125 in	[2721 mm]