

NEW

W-8SP-C



STD

Finish Options

Primed C.R. Steel

Standard

Screw Options

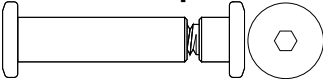

Screw Type: **L**
WC-USB Custom Stainless Steel Hex Drive, Universal Connector Bolt Ø3/8" Or "V" Drill Bit Clearance Hole Required

Optional

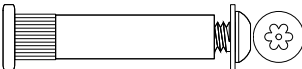

Screw Type: **M**
1/4-20 X 3/4" Stainless Steel Button Head, Tamper-Resistant Torx, Machine Screw With Security Sleeve & Washer

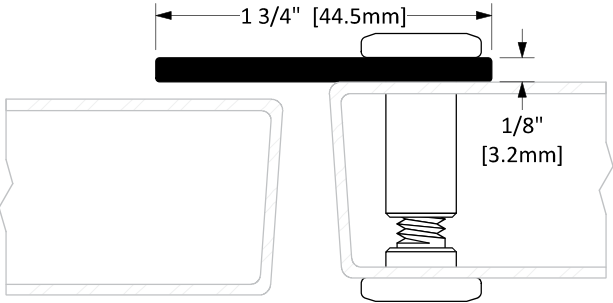

Operation	Astragal
Features	<ul style="list-style-type: none">Primed C.R. Steel with Conditioned EdgesComes with security sleeve & bolt
Application	<ul style="list-style-type: none">Ideal for Residential, Commercial & Industrial

Customer Name:	Job No./Name:	Date:	Provided By:

Notes: